

Waterproof Air Barrier: StoGuard® Waterproof Air Barrier Frame Construction Series 20.xx March 2014

ATTENTION

Sto products are intended for use by qualified professional contractors, not consumers, as a component of a larger construction assembly as specified by a qualified design professional, general contractor or builder. They should be installed in accordance with those specifications and Sto's instructions. Sto Corp. disclaims all, and assumes no, liability for on-site inspections, for its products applied improperly, or by unqualified persons or entities, or as part of an improperly designed or constructed building, for the nonperformance of adjacent building components or assemblies, or for other construction activities beyond Sto's control. Improper use of Sto products or use as part of an improperly designed or constructed larger assembly or building may result in serious damage to Sto products, and to the structure of the building or its components.

STO CORP. DISCLAIMS ALL WARRANTIES EXPRESSED OR IMPLIED EXCEPT FOR EXPLICIT LIMITED WRITTEN WARRANTIES ISSUED TO AND ACCEPTED BY BUILDING OWNERS IN ACCORDANCE WITH STO'S WARRANTY PROGRAMS WHICH ARE SUBJECT TO CHANGE FROM TIME TO TIME. For the fullest, most current information on proper application, clean-up, mixing and other specifications and warranties, cautions and disclaimers, please refer to the Sto Corp. website, www.stocorp.com.

www.stocorp.com



Property of Sto Corp.
All Rights Reserved.

StoGuard® Waterproof Air Barrier Frame Construction Non-absorptive Cladding and Cavity Walls

Detail No.: 20.00a

Date: March 2014

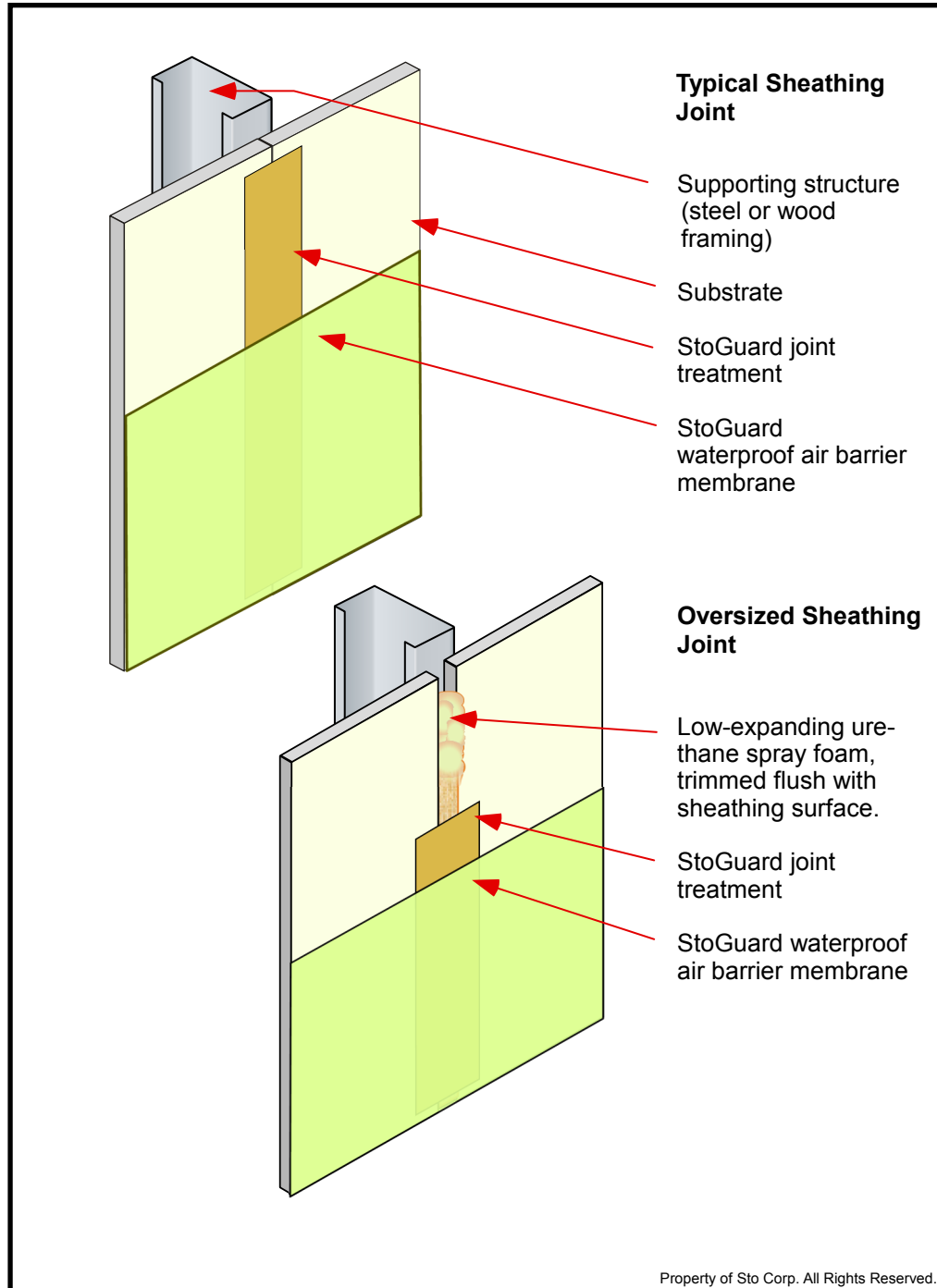

Notes:

- 1] StoGuard joint treatment options:
 - A) StoGuard RapidFill
 - B) Sto Gold Fill® with StoGuard Mesh joints $\leq 1/8"$ (3 mm) wide
 - C) StoGuard Fabric with StoGuard waterproof air barrier membrane joints $\leq 1/8"$ (3 mm) wide
 - D) StoGuard RapidSeal™ with StoGuard Mesh - joints $\leq 1/4"$ (6 mm) wide
- 2] StoGuard waterproof air barrier membrane options:
 - A) Sto EmeraldCoat®
 - B) StoGuard VaporSeal™
 - C) Sto AirSeal™
 - D) Sto Gold Coat®

(Use with StoTherm NExt EIF systems)
- 3] Examples of non-absorptive cladding: fiber-cement board, wood or vinyl siding, metal panel system with sealed joints.
- 4] Refer to Sto specifications and product bulletins for detailed information on substrates and Sto material options.

IMPORTANT: Components not identified as Sto are furnished by other manufacturers and are not necessarily installed by trades who install the Sto products. Refer to project specific contract documents.

Attention

www.stocorp.com

Sto products are intended for use by qualified professional contractors, not consumers, as a component of a larger construction assembly as specified by a qualified design professional, general contractor or builder. They should be installed in accordance with those specifications and Sto's instructions. Sto Corp. disclaims all, and assumes no, liability for on-site inspections, for its products applied improperly, or by unqualified persons or entities, or as part of an improperly designed or constructed building, for the nonperformance of adjacent building components or assemblies, or for other construction activities beyond Sto's control. Improper use of Sto products or use as part of an improperly designed or constructed larger assembly or building may result in serious damage to Sto products, and to the structure of the building or its components. **STO CORP. DISCLAIMS ALL WARRANTIES EXPRESS OR IMPLIED EXCEPT FOR EXPLICIT LIMITED WRITTEN WARRANTIES ISSUED TO AND ACCEPTED BY BUILDING OWNERS IN ACCORDANCE WITH STO'S WARRANTY PROGRAMS WHICH ARE SUBJECT TO CHANGE FROM TIME TO TIME.** For the fullest, most current information on proper application, clean-up, mixing and other specifications and warranties, cautions and disclaimers, please refer to the Sto Corp. website, www.stocorp.com.

StoGuard® Waterproof Air Barrier Frame Construction

Absorptive Cladding

Detail No.: 20.00b

Date: March 2014

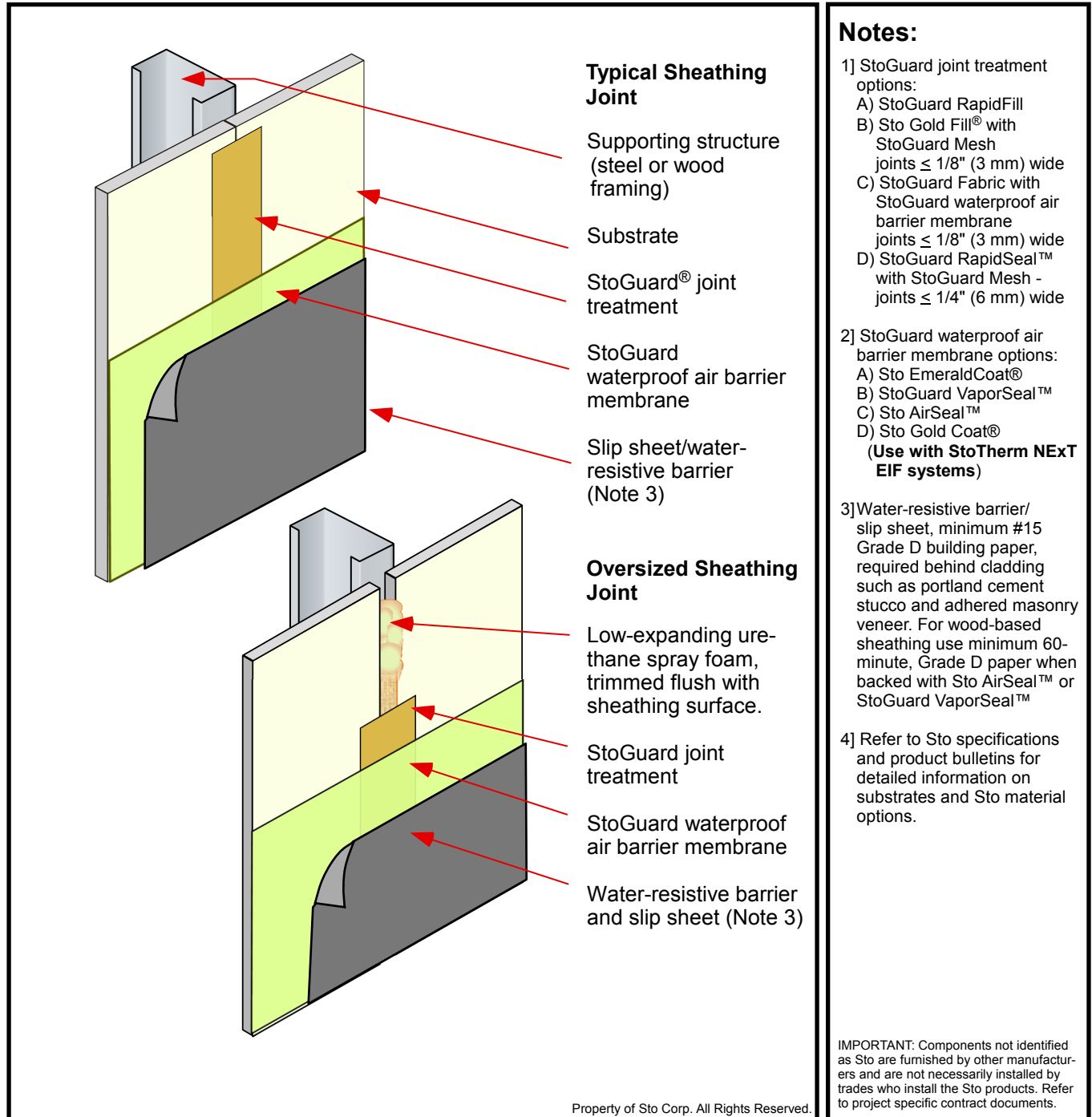

Attention

Sto products are intended for use by qualified professional contractors, not consumers, as a component of a larger construction assembly as specified by a qualified design professional, general contractor or builder. They should be installed in accordance with those specifications and Sto's instructions. Sto Corp. disclaims all, and assumes no, liability for on-site inspections, for its products applied improperly, or by unqualified persons or entities, or as part of an improperly designed or constructed building, for the nonperformance of adjacent building components or assemblies, or for other construction activities beyond Sto's control. Improper use of Sto products or use as part of an improperly designed or constructed larger assembly or building may result in serious damage to Sto products, and to the structure of the building or its components. **STO CORP. DISCLAIMS ALL WARRANTIES EXPRESS OR IMPLIED EXCEPT FOR EXPLICIT LIMITED WRITTEN WARRANTIES ISSUED TO AND ACCEPTED BY BUILDING OWNERS IN ACCORDANCE WITH STO'S WARRANTY PROGRAMS WHICH ARE SUBJECT TO CHANGE FROM TIME TO TIME.** For the fullest, most current information on proper application, clean-up, mixing and other specifications and warranties, cautions and disclaimers, please refer to the Sto Corp. website, www.stocorp.com.

www.stocorp.com

StoGuard® Waterproof Air Barrier Frame Construction

StoGuard® with Furring and Backer Board
(Engineered Wall Design)

Detail No.: 20.00c

Date: March 2014

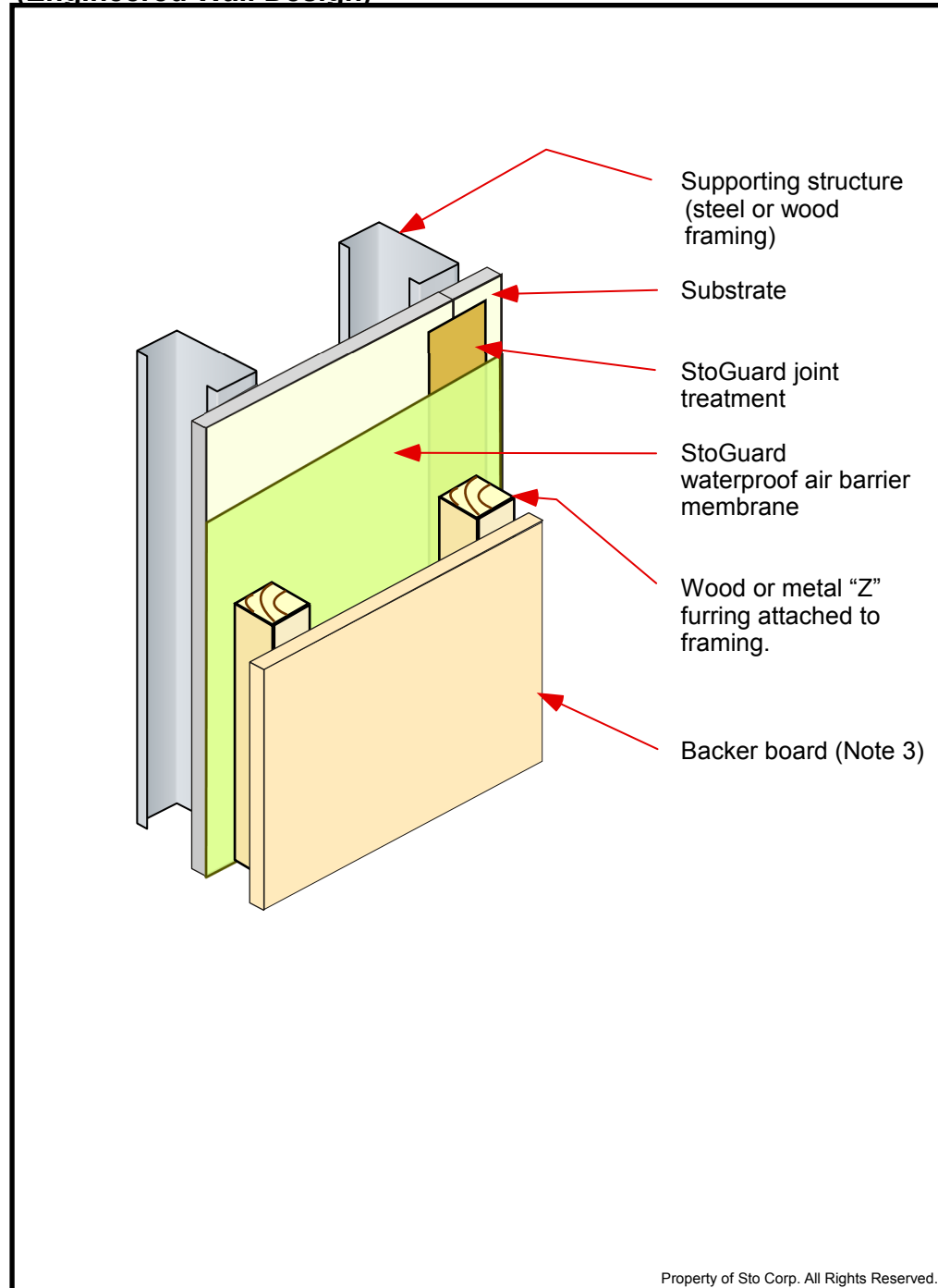

Notes:

- 1] StoGuard joint treatment options:
 - A) StoGuard RapidFill
 - B) Sto Gold Fill® with StoGuard Mesh joints $\leq 1/8"$ (3 mm) wide
 - C) StoGuard Fabric with StoGuard waterproof air barrier membrane joints $\leq 1/8"$ (3 mm) wide
 - D) StoGuard RapidSeal™ with StoGuard Mesh - joints $\leq 1/4"$ (6 mm) wide
- 2] StoGuard waterproof air barrier membrane options:
 - A) Sto EmeraldCoat®
 - B) StoGuard VaporSeal™
 - C) Sto AirSeal™
 - D) Sto Gold Coat®
(Use with StoTherm NExT EIF systems)
- 3] Engineered wall design must take into account furring and cladding attachment, cantilevered load imposed by cladding on fasteners, fire and flame propagation, and other design considerations to conform with or gain compliance with local code requirements.
- 4] Refer to Sto specifications and product bulletins for detailed information on substrates and Sto material options.

IMPORTANT: Components not identified as Sto are furnished by other manufacturers and are not necessarily installed by trades who install the Sto products. Refer to project specific contract documents.

Attention

Sto products are intended for use by qualified professional contractors, not consumers, as a component of a larger construction assembly as specified by a qualified design professional, general contractor or builder. They should be installed in accordance with those specifications and Sto's instructions. Sto Corp. disclaims all, and assumes no, liability for on-site inspections, for its products applied improperly, or by unqualified persons or entities, or as part of an improperly designed or constructed building, for the nonperformance of adjacent building components or assemblies, or for other construction activities beyond Sto's control. Improper use of Sto products or use as part of an improperly designed or constructed larger assembly or building may result in serious damage to Sto products, and to the structure of the building or its components. **STO CORP. DISCLAIMS ALL WARRANTIES EXPRESS OR IMPLIED EXCEPT FOR EXPLICIT LIMITED WRITTEN WARRANTIES ISSUED TO AND ACCEPTED BY BUILDING OWNERS IN ACCORDANCE WITH STO'S WARRANTY PROGRAMS WHICH ARE SUBJECT TO CHANGE FROM TIME TO TIME.** For the fullest, most current information on proper application, clean-up, mixing and other specifications and warranties, cautions and disclaimers, please refer to the Sto Corp. website, www.stocorp.com.

www.stocorp.com

StoGuard® Waterproof Air Barrier Frame Construction

Sto DrainScreen™

Detail No.: 20.00d

Date: March 2014

Non-absorptive Claddings (note 3)

Supporting structure (steel or wood framing)

Substrate

StoGuard joint treatment

StoGuard waterproof air barrier membrane

Sto DrainScreen™ (note 4)

Absorptive Claddings

Water-resistive barrier (Note 4)

Notes:

- 1) StoGuard joint treatment options:
 A) StoGuard RapidFill
 B) Sto Gold Fill® with StoGuard Mesh joints ≤ 1/8" (3 mm) wide
 C) StoGuard Fabric with StoGuard waterproof air barrier membrane joints ≤ 1/8" (3 mm) wide
 D) StoGuard RapidSeal™ with StoGuard Mesh - joints ≤ 1/4" (6 mm) wide
- 2) StoGuard waterproof air barrier membrane options:
 A) Sto EmeraldCoat®
 B) StoGuard VaporSeal™
 C) Sto AirSeal™
 D) Sto Gold Coat®
 (Use with StoTherm NExt EIF systems)
- 3) Examples of non-absorptive claddings include fiber-cement board, wood and vinyl siding, metal panel systems with sealed joints, and brick or stone cavity walls
- 4) Use Sto DrainScreen™ to create a cavity to promote drainage and drying of wall assemblies.
- 5) Water-resistive barrier, minimum #15 Grade D building paper, required behind portland cement stucco and adhered masonry veneer. For wood-based substrates use minimum 60-minute, Grade D paper when backed by Sto AirSeal™ or StoGuard VaporSeal™.
- 6) Refer to Sto specifications and product bulletins for detailed information on substrates and Sto material options.

IMPORTANT: Components not identified as Sto are furnished by other manufacturers and are not necessarily installed by trades who install the Sto products. Refer to project specific contract documents.

Property of Sto Corp. All Rights Reserved.

Attention

Sto products are intended for use by qualified professional contractors, not consumers, as a component of a larger construction assembly as specified by a qualified design professional, general contractor or builder. They should be installed in accordance with those specifications and Sto's instructions. Sto Corp. disclaims all, and assumes no, liability for on-site inspections, for its products applied improperly, or by unqualified persons or entities, or as part of an improperly designed or constructed building, for the nonperformance of adjacent building components or assemblies, or for other construction activities beyond Sto's control. Improper use of Sto products or use as part of an improperly designed or constructed larger assembly or building may result in serious damage to Sto products, and to the structure of the building or its components. **STO CORP. DISCLAIMS ALL WARRANTIES EXPRESS OR IMPLIED EXCEPT FOR EXPLICIT LIMITED WRITTEN WARRANTIES ISSUED TO AND ACCEPTED BY BUILDING OWNERS IN ACCORDANCE WITH STO'S WARRANTY PROGRAMS WHICH ARE SUBJECT TO CHANGE FROM TIME TO TIME.** For the fullest, most current information on proper application, clean-up, mixing and other specifications and warranties, cautions and disclaimers, please refer to the Sto Corp. website, www.stocorp.com.

www.stocorp.com

StoGuard® Waterproof Air Barrier Frame Construction

Continuous Insulation - Brick Cavity or Other Cladding

Detail No.: 20.00e

Date: March 2014

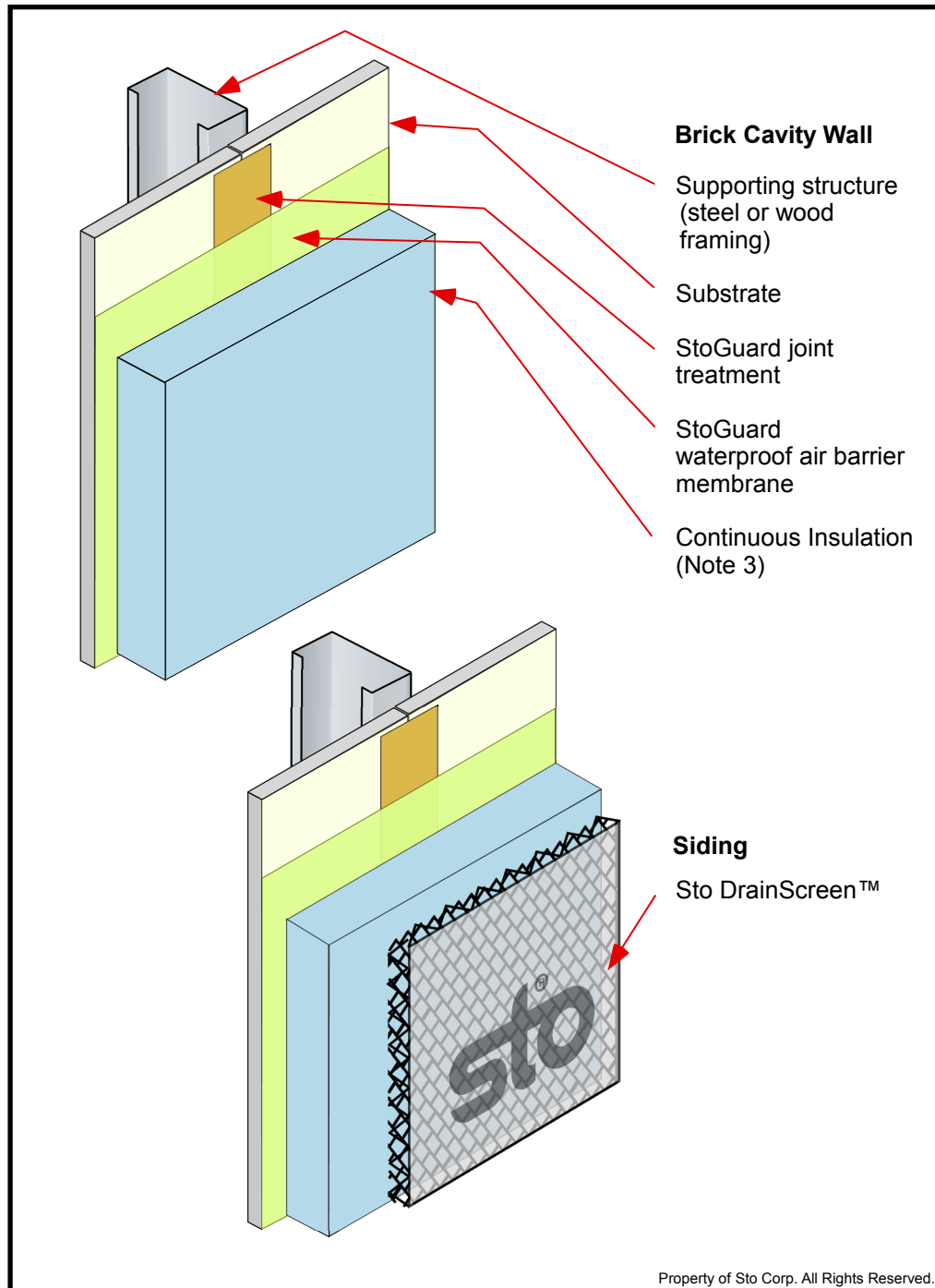

Notes:

- 1] StoGuard joint treatment options:
 - A) StoGuard RapidFill
 - B) Sto Gold Fill® with StoGuard Mesh joints $\leq 1/8"$ (3 mm) wide
 - C) StoGuard Fabric with StoGuard waterproof air barrier membrane joints $\leq 1/8"$ (3 mm) wide
 - D) StoGuard RapidSeal™ with StoGuard Mesh - joints $\leq 1/4"$ (6 mm) wide
- 2] StoGuard waterproof air barrier membrane options:
 - A) Sto EmeraldCoat®
 - B) StoGuard VaporSeal™
 - C) Sto AirSeal™
 - D) Sto Gold Coat®

(Use with StoTherm NExT EIF systems)
- 3] Continuous foam plastic insulation must be approved and in conformance with IRC Section 316 and IBC Section 2603 (note required fire tests for use on noncombustible construction). Consult with cladding manufacturer for required supports, attachment and limitations for assemblies involving continuous insulation.
- 4] Refer to Sto specifications and product bulletins for detailed information on substrates and Sto material options.

IMPORTANT: Components not identified as Sto are furnished by other manufacturers and are not necessarily installed by trades who install the Sto products. Refer to project specific contract documents.

Property of Sto Corp. All Rights Reserved.

Attention

Sto products are intended for use by qualified professional contractors, not consumers, as a component of a larger construction assembly as specified by a qualified design professional, general contractor or builder. They should be installed in accordance with those specifications and Sto's instructions. Sto Corp. disclaims all, and assumes no, liability for on-site inspections, for its products applied improperly, or by unqualified persons or entities, or as part of an improperly designed or constructed building, for the nonperformance of adjacent building components or assemblies, or for other construction activities beyond Sto's control. Improper use of Sto products or use as part of an improperly designed or constructed larger assembly or building may result in serious damage to Sto products, and to the structure of the building or its components. **STO CORP. DISCLAIMS ALL WARRANTIES EXPRESS OR IMPLIED EXCEPT FOR EXPLICIT LIMITED WRITTEN WARRANTIES ISSUED TO AND ACCEPTED BY BUILDING OWNERS IN ACCORDANCE WITH STO'S WARRANTY PROGRAMS WHICH ARE SUBJECT TO CHANGE FROM TIME TO TIME.** For the fullest, most current information on proper application, clean-up, mixing and other specifications and warranties, cautions and disclaimers, please refer to the Sto Corp. website, www.stocorp.com.

www.stocorp.com

StoGuard® Waterproof Air Barrier Frame Construction

Continuous Insulation - Portland Cement Stucco and
Adhered Masonry Veneer

Detail No.: 20.00f

Date: March 2013

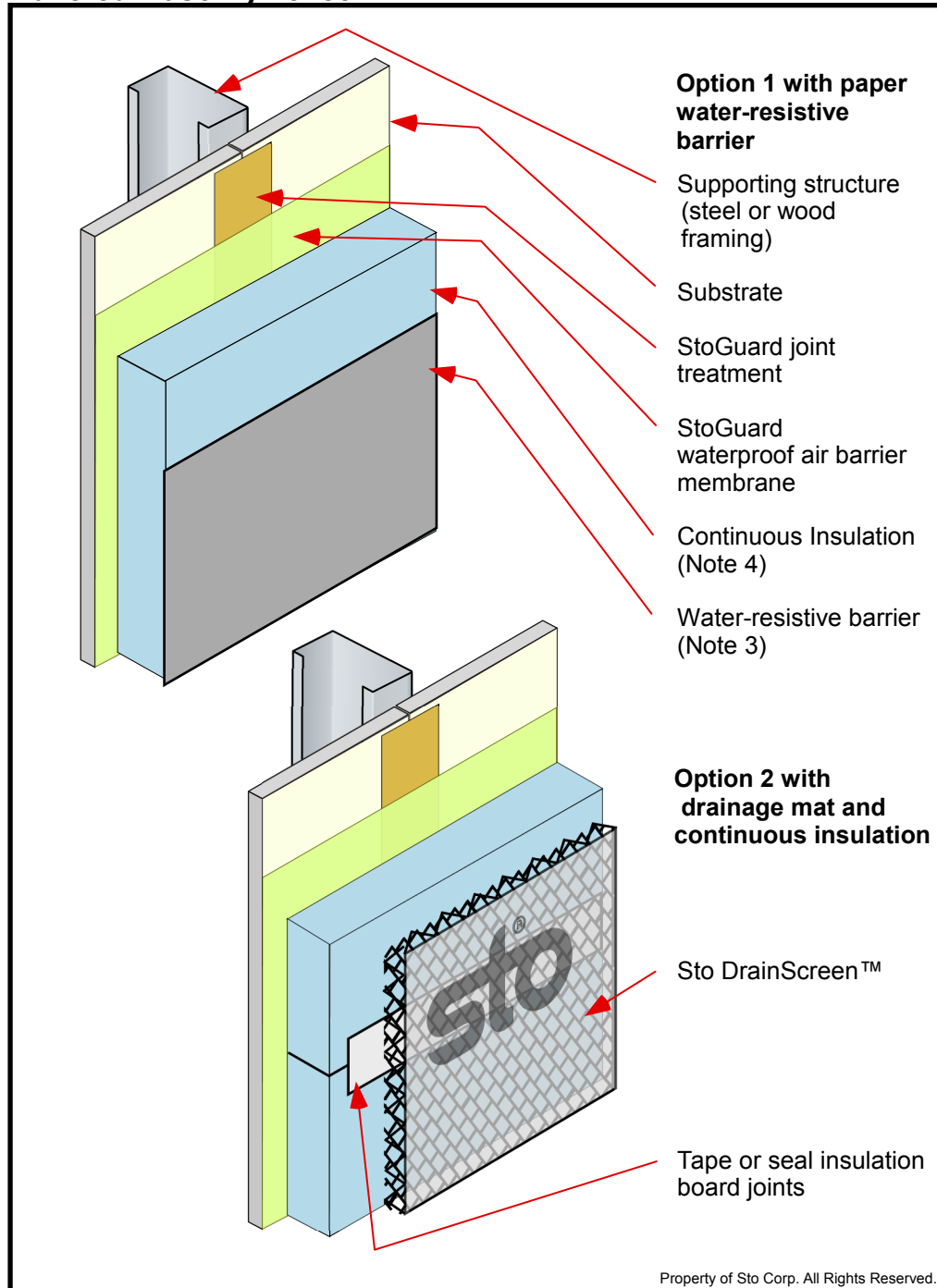

Notes:

- 1] StoGuard joint treatment options:
 - A) StoGuard RapidFill
 - B) Sto Gold Fill® with StoGuard Mesh joints $\leq 1/8"$ (3 mm) wide
 - C) StoGuard Fabric with StoGuard waterproof air barrier membrane joints $\leq 1/8"$ (3 mm) wide
 - D) StoGuard RapidSeal™ with StoGuard Mesh - joints $\leq 1/4"$ (6 mm) wide
- 2] StoGuard waterproof air barrier membrane options:
 - A) Sto EmeraldCoat®
 - B) StoGuard VaporSeal™
 - C) Sto AirSeal™
 - D) Sto Gold Coat® (Use with StoTherm NExT EIF systems)
- 3] Water-resistant barrier/slip sheet, minimum #15 Grade D building paper, required behind claddings such as portland cement stucco and adhered masonry veneer. For wood-based sheathing use minimum 60-minute, Grade D paper when backed with Sto AirSeal™ or StoGuard VaporSeal™
- 4] Continuous foam plastic insulation must be approved and in conformance with IRC Section 316 and IBC Section 2603 (note required fire tests for use on noncombustible construction). Consult with cladding manufacturer for required supports, attachment and limitations for assemblies involving continuous insulation.
- 5] Refer to Sto specifications and product bulletins for detailed information on substrates and Sto material options.

IMPORTANT: Components not identified as Sto are furnished by other manufacturers and are not necessarily installed by trades who install the Sto products. Refer to project specific contract documents.

Attention

Sto products are intended for use by qualified professional contractors, not consumers, as a component of a larger construction assembly as specified by a qualified design professional, general contractor or builder. They should be installed in accordance with those specifications and Sto's instructions. Sto Corp. disclaims all, and assumes no, liability for on-site inspections, for its products applied improperly, or by unqualified persons or entities, or as part of an improperly designed or constructed building, for the nonperformance of adjacent building components or assemblies, or for other construction activities beyond Sto's control. Improper use of Sto products or use as part of an improperly designed or constructed larger assembly or building may result in serious damage to Sto products, and to the structure of the building or its components. **STO CORP. DISCLAIMS ALL WARRANTIES EXPRESS OR IMPLIED EXCEPT FOR EXPLICIT LIMITED WRITTEN WARRANTIES ISSUED TO AND ACCEPTED BY BUILDING OWNERS IN ACCORDANCE WITH STO'S WARRANTY PROGRAMS WHICH ARE SUBJECT TO CHANGE FROM TIME TO TIME.** For the fullest, most current information on proper application, clean-up, mixing and other specifications and warranties, cautions and disclaimers, please refer to the Sto Corp. website, www.stocorp.com.

www.stocorp.com

StoGuard® Waterproof Air Barrier Frame Construction

Inside Corner - Common Substrate

Detail No.: 20.01

Date: March 2014

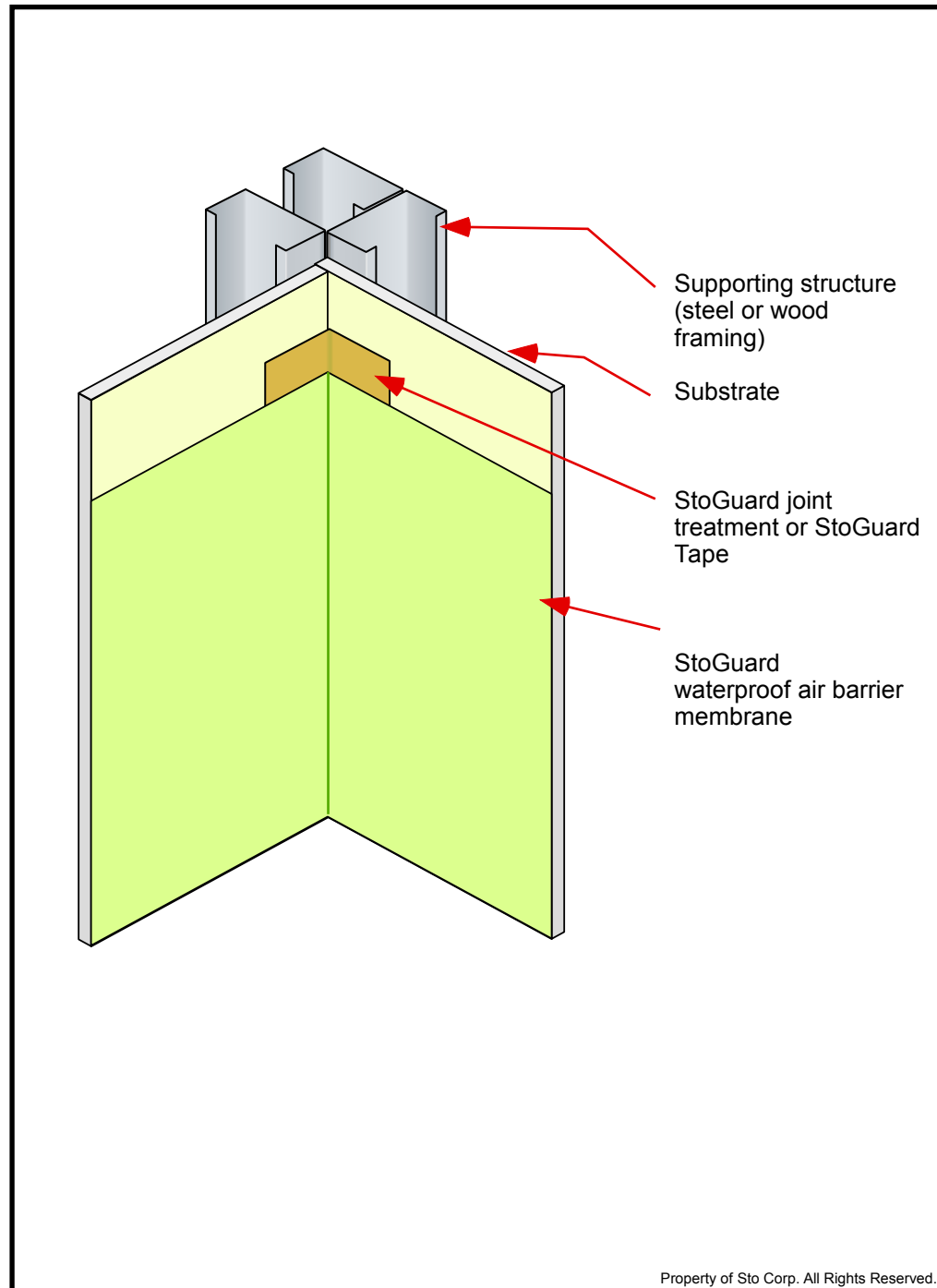

Notes:

- 1] StoGuard joint treatment options:
 - A) StoGuard RapidFill
 - B) Sto Gold Fill® with StoGuard Mesh joints $\leq 1/8"$ (3 mm) wide
 - C) StoGuard Fabric with StoGuard waterproof air barrier membrane joints $\leq 1/8"$ (3 mm) wide
 - D) StoGuard RapidSeal™ with StoGuard Mesh - joints $\leq 1/4"$ (6 mm) wide
- 2] StoGuard waterproof air barrier membrane options:
 - A) Sto EmeraldCoat®
 - B) StoGuard VaporSeal™
 - C) Sto AirSeal™
 - D) Sto Gold Coat®

(Use with StoTherm NExt EIF systems)
- 3] Refer to Sto specifications and product bulletins for detailed information on substrates and Sto material options. Additional water-resistive barrier/slip sheet required behind some claddings not shown. Refer to Sto Detail 20.00b for additional information.

IMPORTANT: Components not identified as Sto are furnished by other manufacturers and are not necessarily installed by trades who install the Sto products. Refer to project specific contract documents.

Attention

Sto products are intended for use by qualified professional contractors, not consumers, as a component of a larger construction assembly as specified by a qualified design professional, general contractor or builder. They should be installed in accordance with those specifications and Sto's instructions. Sto Corp. disclaims all, and assumes no, liability for on-site inspections, for its products applied improperly, or by unqualified persons or entities, or as part of an improperly designed or constructed building, for the nonperformance of adjacent building components or assemblies, or for other construction activities beyond Sto's control. Improper use of Sto products or use as part of an improperly designed or constructed larger assembly or building may result in serious damage to Sto products, and to the structure of the building or its components. **STO CORP. DISCLAIMS ALL WARRANTIES EXPRESS OR IMPLIED EXCEPT FOR EXPLICIT LIMITED WRITTEN WARRANTIES ISSUED TO AND ACCEPTED BY BUILDING OWNERS IN ACCORDANCE WITH STO'S WARRANTY PROGRAMS WHICH ARE SUBJECT TO CHANGE FROM TIME TO TIME.** For the fullest, most current information on proper application, clean-up, mixing and other specifications and warranties, cautions and disclaimers, please refer to the Sto Corp. website, www.stocorp.com.

www.stocorp.com

StoGuard® Waterproof Air Barrier Frame Construction

Outside Corner

Detail No.: 20.02

Date: March 2014

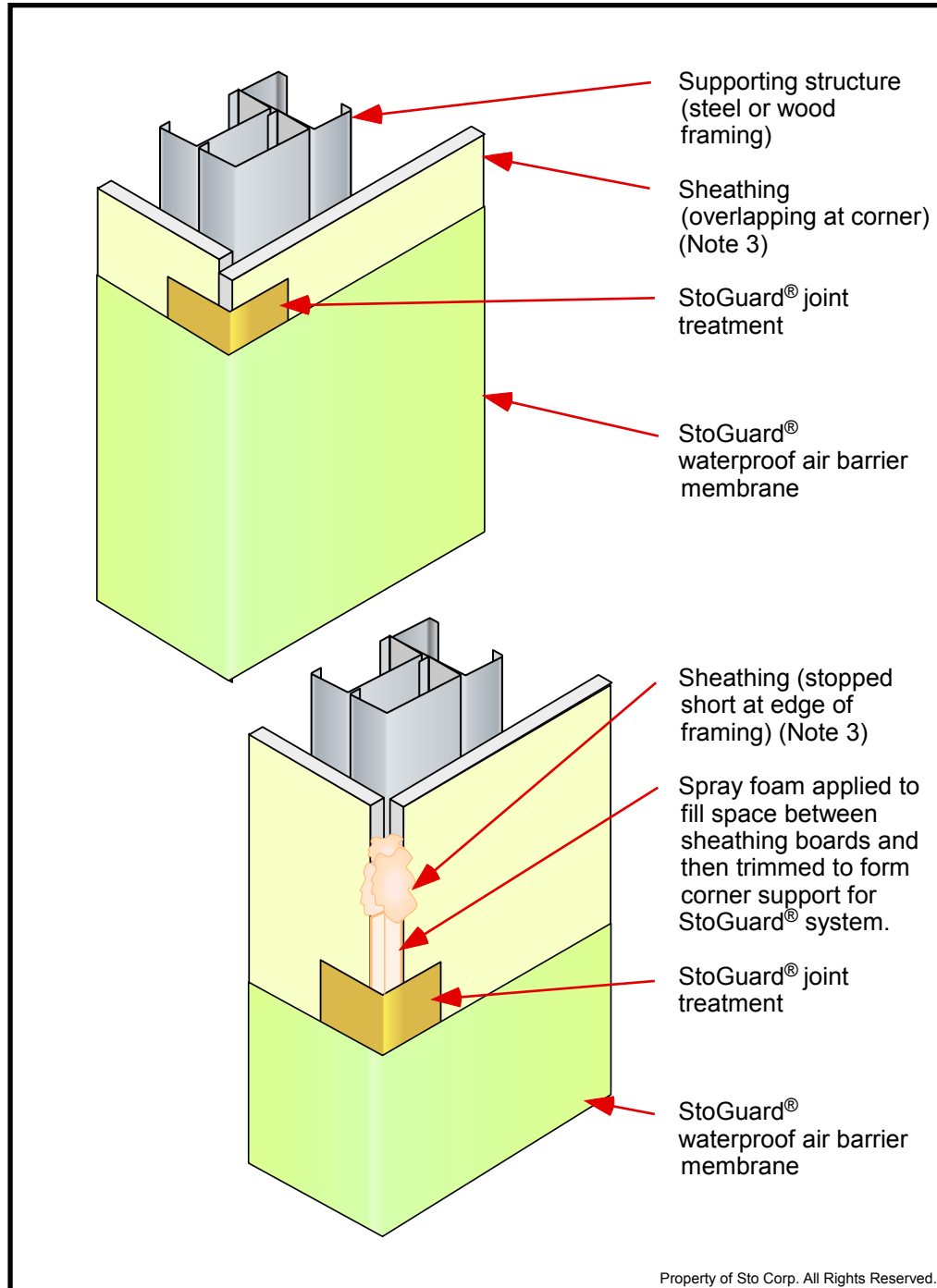

Notes:

- 1] StoGuard joint treatment options:
 - A) StoGuard RapidFill
 - B) Sto Gold Fill® with StoGuard Mesh joints $\leq 1/8"$ (3 mm) wide
 - C) StoGuard Fabric with StoGuard waterproof air barrier membrane joints $\leq 1/8"$ (3 mm) wide
 - D) StoGuard RapidSeal™ with StoGuard Mesh - joints $\leq 1/4"$ (6 mm) wide
- 2] StoGuard waterproof air barrier membrane options:
 - A) Sto EmeraldCoat®
 - B) StoGuard VaporSeal™
 - C) Sto AirSeal™
 - D) Sto Gold Coat®

(Use with StoTherm NExt EIF systems)
- 3] Best practice is to overlap sheathing as shown in detail "A". Detail "B" presents an option to accommodate minor construction variations: maximum 5/8-in. x 5/8-in. (16 mm x 16 mm) gap at corner.
- 4] Refer to Sto specifications and product bulletins for detailed information on substrates and Sto material options. Additional water-resistive barrier/slip sheet required behind some claddings not shown. Refer to Sto Detail 20.00b for additional information.

IMPORTANT: Components not identified as Sto are furnished by other manufacturers and are not necessarily installed by trades who install the Sto products. Refer to project specific contract documents.

Attention

Sto products are intended for use by qualified professional contractors, not consumers, as a component of a larger construction assembly as specified by a qualified design professional, general contractor or builder. They should be installed in accordance with those specifications and Sto's instructions. Sto Corp. disclaims all, and assumes no, liability for on-site inspections, for its products applied improperly, or by unqualified persons or entities, or as part of an improperly designed or constructed building, for the nonperformance of adjacent building components or assemblies, or for other construction activities beyond Sto's control. Improper use of Sto products or use as part of an improperly designed or constructed larger assembly or building may result in serious damage to Sto products, and to the structure of the building or its components. **STO CORP. DISCLAIMS ALL WARRANTIES EXPRESS OR IMPLIED EXCEPT FOR EXPLICIT LIMITED WRITTEN WARRANTIES ISSUED TO AND ACCEPTED BY BUILDING OWNERS IN ACCORDANCE WITH STO'S WARRANTY PROGRAMS WHICH ARE SUBJECT TO CHANGE FROM TIME TO TIME.** For the fullest, most current information on proper application, clean-up, mixing and other specifications and warranties, cautions and disclaimers, please refer to the Sto Corp. website, www.stocorp.com.

www.stocorp.com

StoGuard® Waterproof Air Barrier Frame Construction

Brick Ledge at Foundation with Masonry Anchors - Steel Frame

Detail No.: 20.03a

Date: March 2014

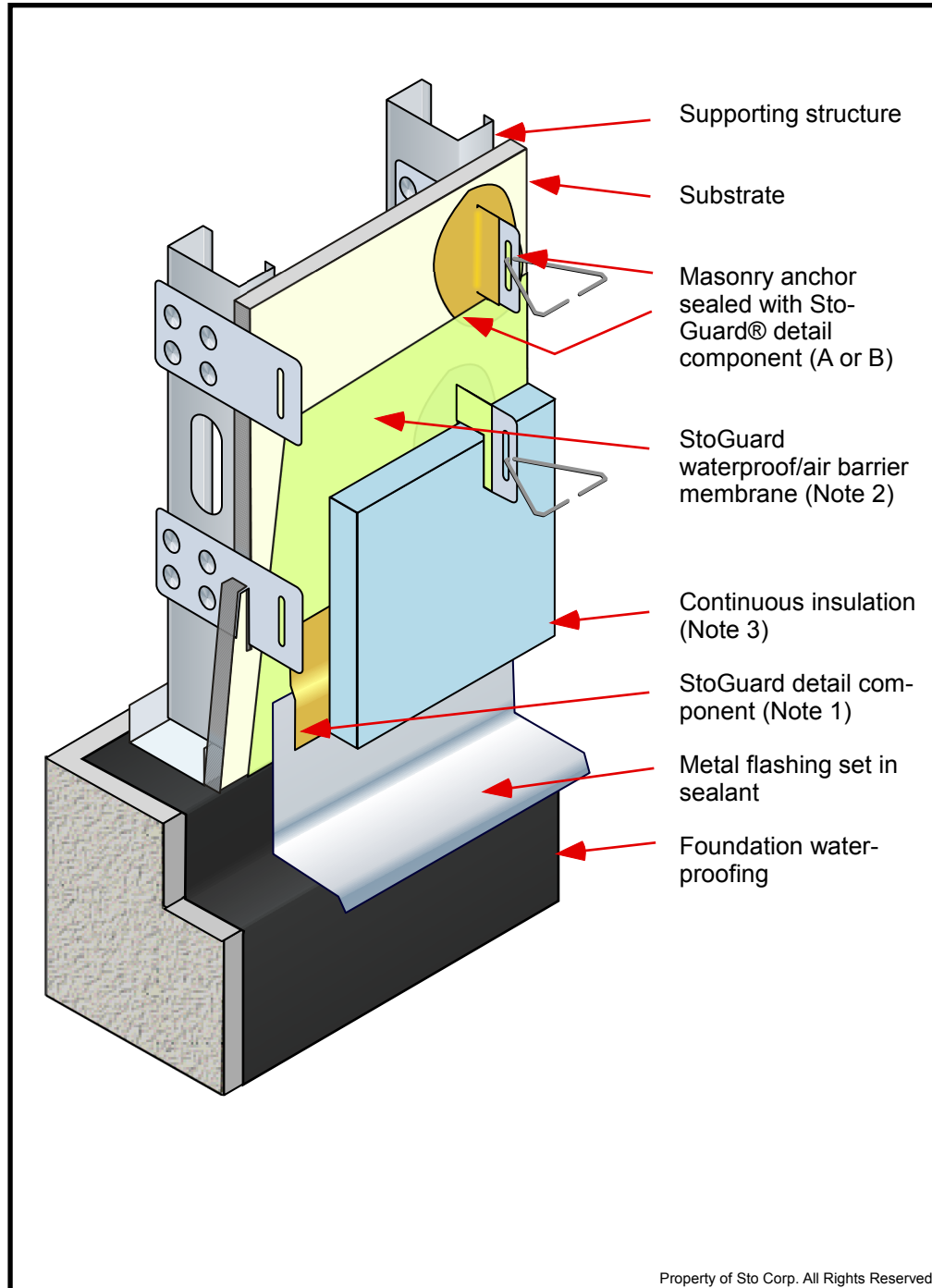

Notes:

- 1] StoGuard detail component options:
 A) StoGuard RapidFill
 B) Sto Gold Fill® with StoGuard Mesh
 C) StoGuard Fabric with StoGuard waterproof air barrier membrane
 D) StoGuard RapidSeal™ with StoGuard Mesh
- 2] StoGuard waterproof air barrier membrane options:
 A) Sto EmeraldCoat®
 B) StoGuard VaporSeal™
 C) Sto AirSeal™
 D) Sto Gold Coat®
 (Use with StoTherm NExT EIF systems)
- 3] Continuous foam plastic insulation must be approved and in conformance with IRC Section 316 and IBC Section 2603 (note required fire tests for use on noncombustible construction).
- 4] Refer to Sto specifications and product bulletins for detailed information on substrates and Sto material options. Additional water-resistive barrier and slip sheet required behind porous claddings not shown. Refer to Sto Detail 20.00b for additional information.

IMPORTANT: Components not identified as Sto are furnished by other manufacturers and are not necessarily installed by trades who install the Sto products. Refer to project specific contract documents.

Property of Sto Corp. All Rights Reserved.

Attention

www.stocorp.com

Sto products are intended for use by qualified professional contractors, not consumers, as a component of a larger construction assembly as specified by a qualified design professional, general contractor or builder. They should be installed in accordance with those specifications and Sto's instructions. Sto Corp. disclaims all, and assumes no, liability for on-site inspections, for its products applied improperly, or by unqualified persons or entities, or as part of an improperly designed or constructed building, for the nonperformance of adjacent building components or assemblies, or for other construction activities beyond Sto's control. Improper use of Sto products or use as part of an improperly designed or constructed larger assembly or building may result in serious damage to Sto products, and to the structure of the building or its components. **STO CORP. DISCLAIMS ALL WARRANTIES EXPRESS OR IMPLIED EXCEPT FOR EXPLICIT LIMITED WRITTEN WARRANTIES ISSUED TO AND ACCEPTED BY BUILDING OWNERS IN ACCORDANCE WITH STO'S WARRANTY PROGRAMS WHICH ARE SUBJECT TO CHANGE FROM TIME TO TIME.** For the fullest, most current information on proper application, clean-up, mixing and other specifications and warranties, cautions and disclaimers, please refer to the Sto Corp. website, www.stocorp.com.

StoGuard® Waterproof Air Barrier Frame Construction

Masonry Anchor Backer Seal

Detail No.: 20.03c

Date: March 2014

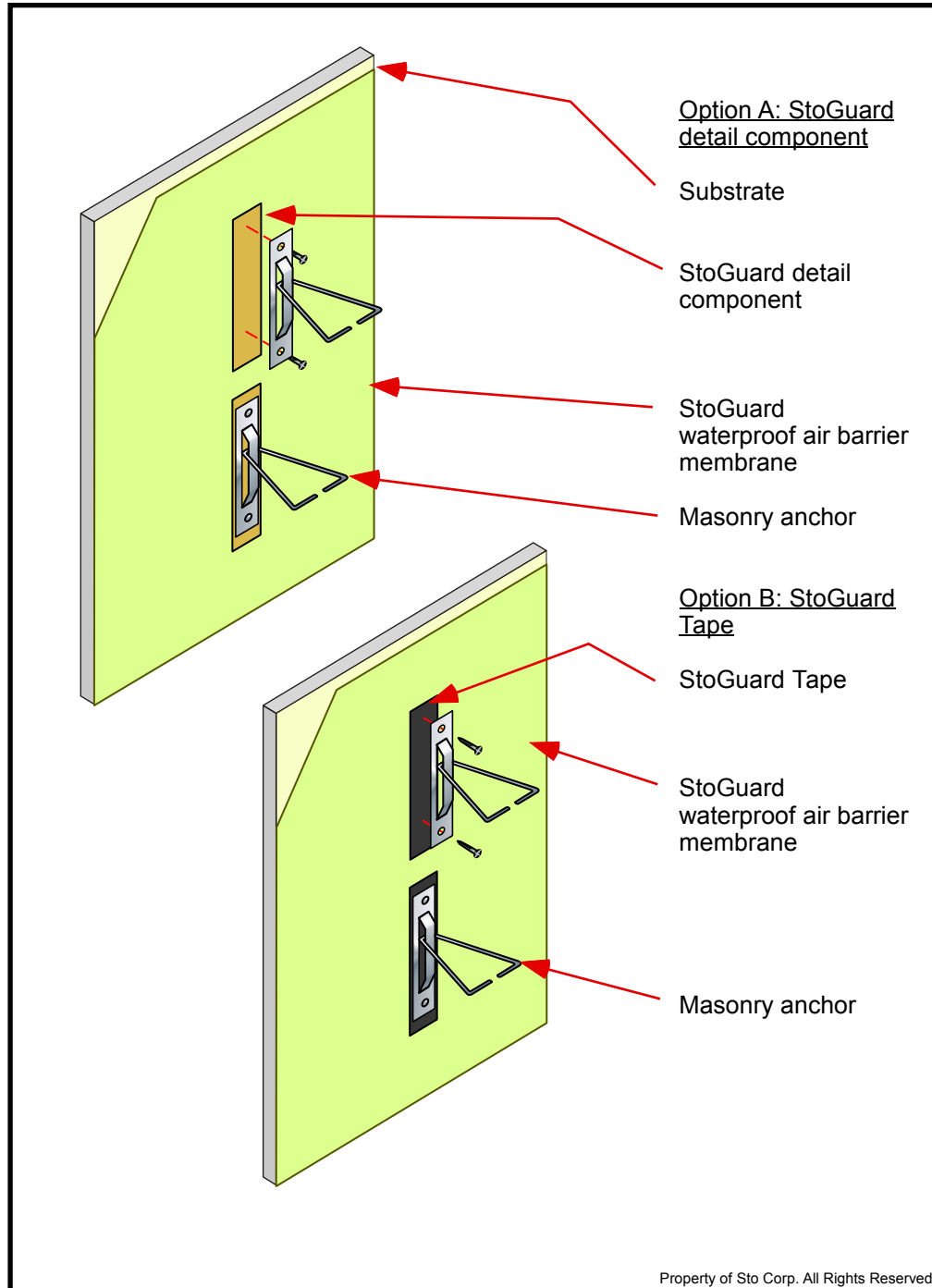

Notes:

- 1] StoGuard detail component options:
A) StoGuard RapidFill
B) StoGuard RapidSeal™
- 2] StoGuard waterproof air barrier membrane options:
A) Sto EmeraldCoat®
B) StoGuard VaporSeal™
C) Sto AirSeal™
D) Sto Gold Coat®
(Use with StoTherm NExt EIF systems)
- 3] Caution: All fasteners should be into framing with fastener head snug to tie surface. Remove fasteners and seal all penetrations where studs are missed using StoGuard detail component or compatible sealant.
- 4] Refer to Sto specifications and product bulletins for detailed information on substrates and Sto material options. Additional water-resistive barrier/slip sheet required behind some claddings not shown. Refer to Sto Detail 20.00b for additional information.

IMPORTANT: Components not identified as Sto are furnished by other manufacturers and are not necessarily installed by trades who install the Sto products. Refer to project specific contract documents.

Attention

Sto products are intended for use by qualified professional contractors, not consumers, as a component of a larger construction assembly as specified by a qualified design professional, general contractor or builder. They should be installed in accordance with those specifications and Sto's instructions. Sto Corp. disclaims all, and assumes no, liability for on-site inspections, for its products applied improperly, or by unqualified persons or entities, or as part of an improperly designed or constructed building, for the nonperformance of adjacent building components or assemblies, or for other construction activities beyond Sto's control. Improper use of Sto products or use as part of an improperly designed or constructed larger assembly or building may result in serious damage to Sto products, and to the structure of the building or its components. **STO CORP. DISCLAIMS ALL WARRANTIES EXPRESS OR IMPLIED EXCEPT FOR EXPLICIT LIMITED WRITTEN WARRANTIES ISSUED TO AND ACCEPTED BY BUILDING OWNERS IN ACCORDANCE WITH STO'S WARRANTY PROGRAMS WHICH ARE SUBJECT TO CHANGE FROM TIME TO TIME.** For the fullest, most current information on proper application, clean-up, mixing and other specifications and warranties, cautions and disclaimers, please refer to the Sto Corp. website, www.stocorp.com.

www.stocorp.com

StoGuard® Waterproof Air Barrier Frame Construction

Termination at Grade - Sheathing Flush with Foundation

Detail No.: 20.10a

Date: March 2014

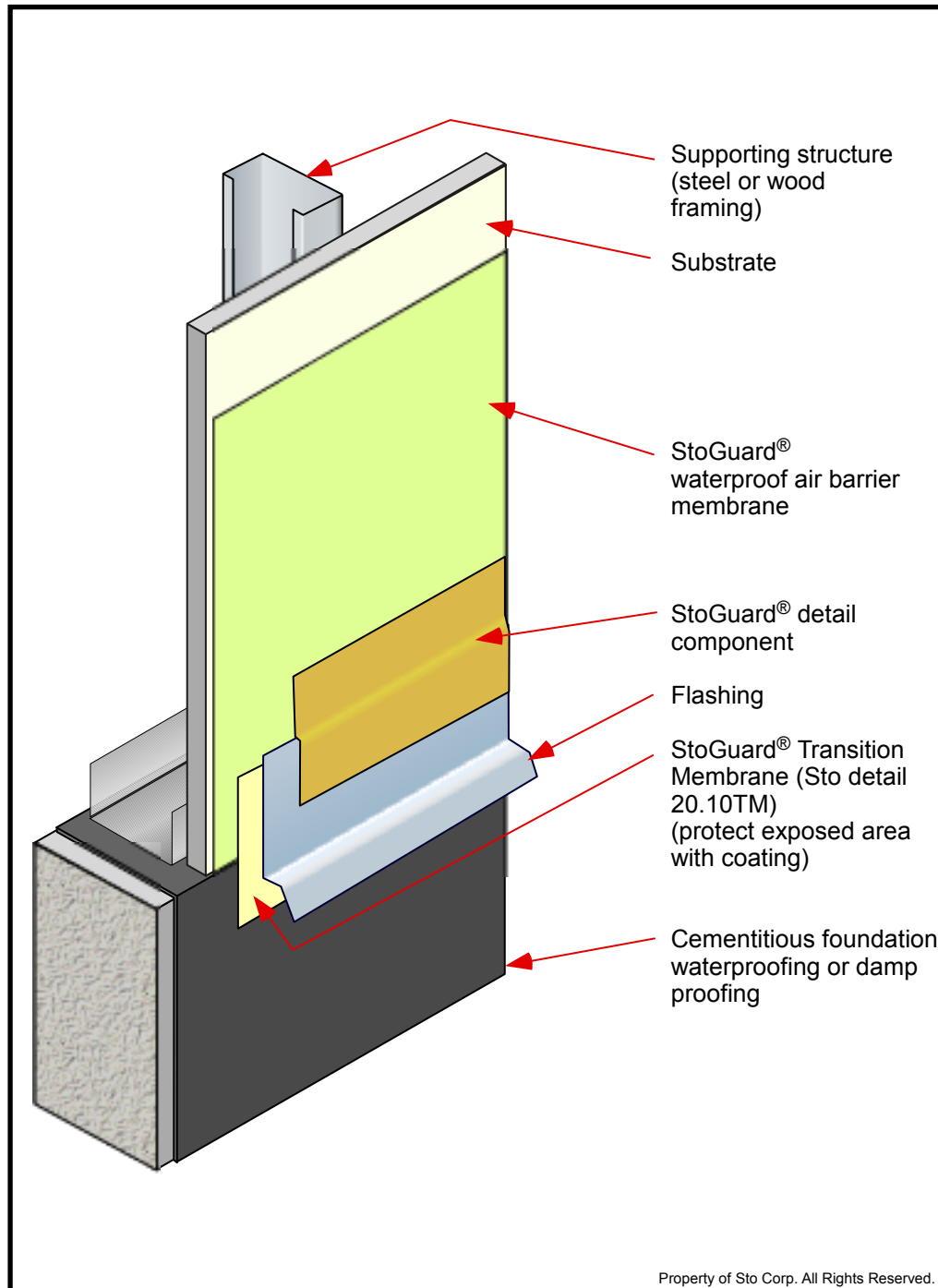

Notes:

- 1] StoGuard detail component options:
 - A) StoGuard RapidFill
 - B) Sto Gold Fill® with StoGuard Mesh
 - C) StoGuard Fabric with StoGuard waterproof air barrier membrane
 - D) StoGuard RapidSeal™ with StoGuard Mesh
- 2] StoGuard waterproof air barrier membrane options:
 - A) Sto EmeraldCoat®
 - B) StoGuard VaporSeal™
 - C) Sto AirSeal™
 - D) Sto Gold Coat®

(Use with StoTherm NExT EIF systems)
- 3] Refer to Sto specifications and product bulletins for detailed information on substrates and Sto material options. Additional water-resistive barrier /slip sheet required behind some claddings not shown. Refer to Sto Detail 20.00b for additional information.

IMPORTANT: Components not identified as Sto are furnished by other manufacturers and are not necessarily installed by trades who install the Sto products. Refer to project specific contract documents.

Property of Sto Corp. All Rights Reserved.

Attention

www.stocorp.com

Sto products are intended for use by qualified professional contractors, not consumers, as a component of a larger construction assembly as specified by a qualified design professional, general contractor or builder. They should be installed in accordance with those specifications and Sto's instructions. Sto Corp. disclaims all, and assumes no, liability for on-site inspections, for its products applied improperly, or by unqualified persons or entities, or as part of an improperly designed or constructed building, for the nonperformance of adjacent building components or assemblies, or for other construction activities beyond Sto's control. Improper use of Sto products or use as part of an improperly designed or constructed larger assembly or building may result in serious damage to Sto products, and to the structure of the building or its components. **STO CORP. DISCLAIMS ALL WARRANTIES EXPRESS OR IMPLIED EXCEPT FOR EXPLICIT LIMITED WRITTEN WARRANTIES ISSUED TO AND ACCEPTED BY BUILDING OWNERS IN ACCORDANCE WITH STO'S WARRANTY PROGRAMS WHICH ARE SUBJECT TO CHANGE FROM TIME TO TIME.** For the fullest, most current information on proper application, clean-up, mixing and other specifications and warranties, cautions and disclaimers, please refer to the Sto Corp. website, www.stocorp.com.

StoGuard® Waterproof Air Barrier Frame Construction

Termination at Grade - Sheathing Overlapping Foundation

Detail No.: 20.10b

Date: March 2014

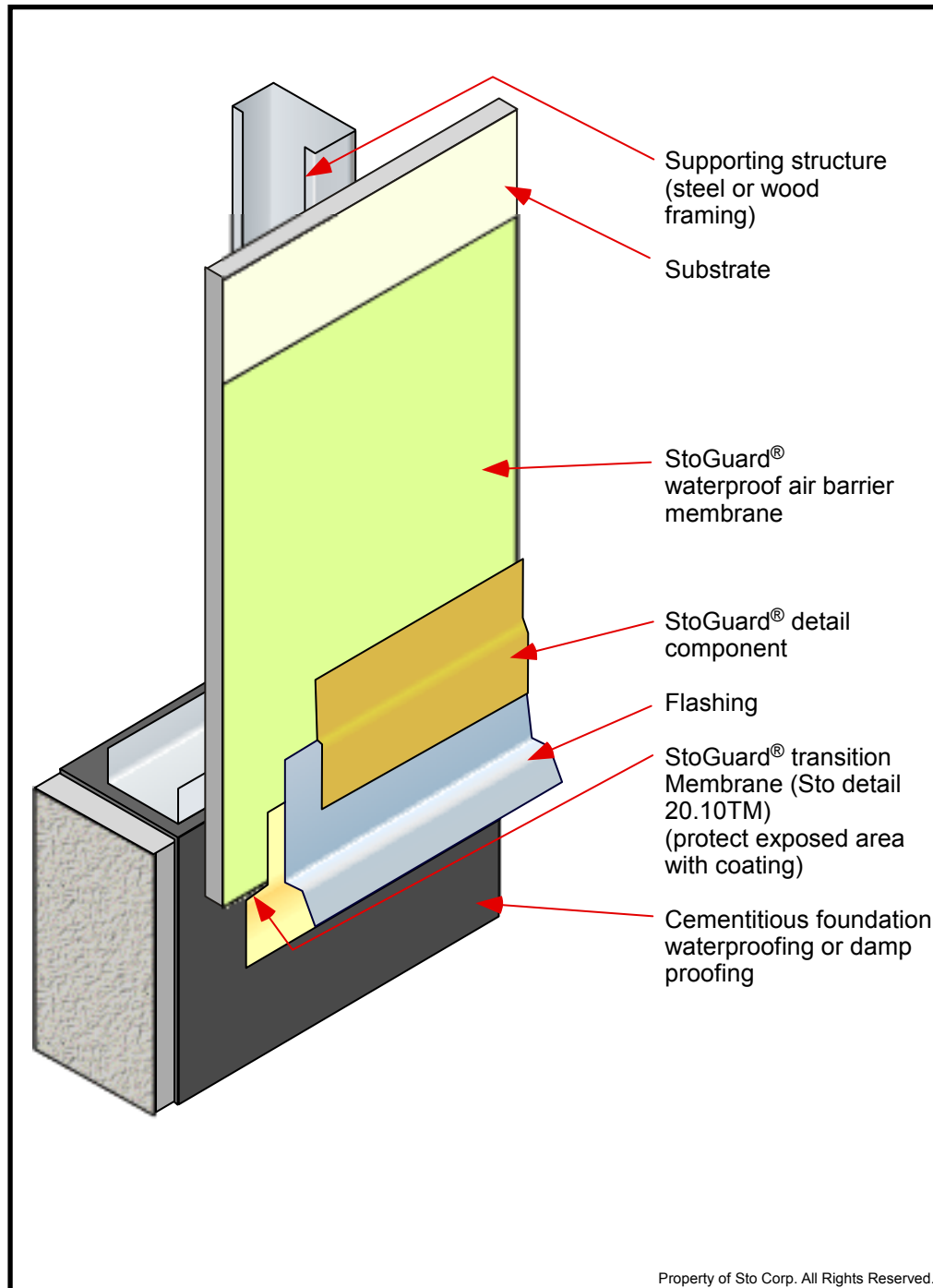

Notes:

- 1] StoGuard detail component options:
 - A) StoGuard RapidFill
 - B) Sto Gold Fill® with StoGuard Mesh
 - C) StoGuard Fabric with StoGuard waterproof air barrier membrane
 - D) StoGuard RapidSeal™ with StoGuard Mesh -
- 2] StoGuard waterproof air barrier membrane options:
 - A) Sto EmeraldCoat®
 - B) StoGuard VaporSeal™
 - C) Sto AirSeal™
 - D) Sto Gold Coat®

(Use with StoTherm NExT EIF systems)
- 3] Refer to Sto specifications and product bulletins for detailed information on substrates and Sto material options. Additional water-resistive barrier /slip sheet required behind some claddings not shown. Refer to Sto Detail 20.00b for additional information.

IMPORTANT: Components not identified as Sto are furnished by other manufacturers and are not necessarily installed by trades who install the Sto products. Refer to project specific contract documents.

Property of Sto Corp. All Rights Reserved.

Attention

www.stocorp.com

Sto products are intended for use by qualified professional contractors, not consumers, as a component of a larger construction assembly as specified by a qualified design professional, general contractor or builder. They should be installed in accordance with those specifications and Sto's instructions. Sto Corp. disclaims all, and assumes no, liability for on-site inspections, for its products applied improperly, or by unqualified persons or entities, or as part of an improperly designed or constructed building, for the nonperformance of adjacent building components or assemblies, or for other construction activities beyond Sto's control. Improper use of Sto products or use as part of an improperly designed or constructed larger assembly or building may result in serious damage to Sto products, and to the structure of the building or its components. **STO CORP. DISCLAIMS ALL WARRANTIES EXPRESS OR IMPLIED EXCEPT FOR EXPLICIT LIMITED WRITTEN WARRANTIES ISSUED TO AND ACCEPTED BY BUILDING OWNERS IN ACCORDANCE WITH STO'S WARRANTY PROGRAMS WHICH ARE SUBJECT TO CHANGE FROM TIME TO TIME.** For the fullest, most current information on proper application, clean-up, mixing and other specifications and warranties, cautions and disclaimers, please refer to the Sto Corp. website, www.stocorp.com.

StoGuard® Waterproof Air Barrier Frame Construction Rough Opening Protection with StoGuard Fabric

Detail No.: 20.20F

Date: March 2014

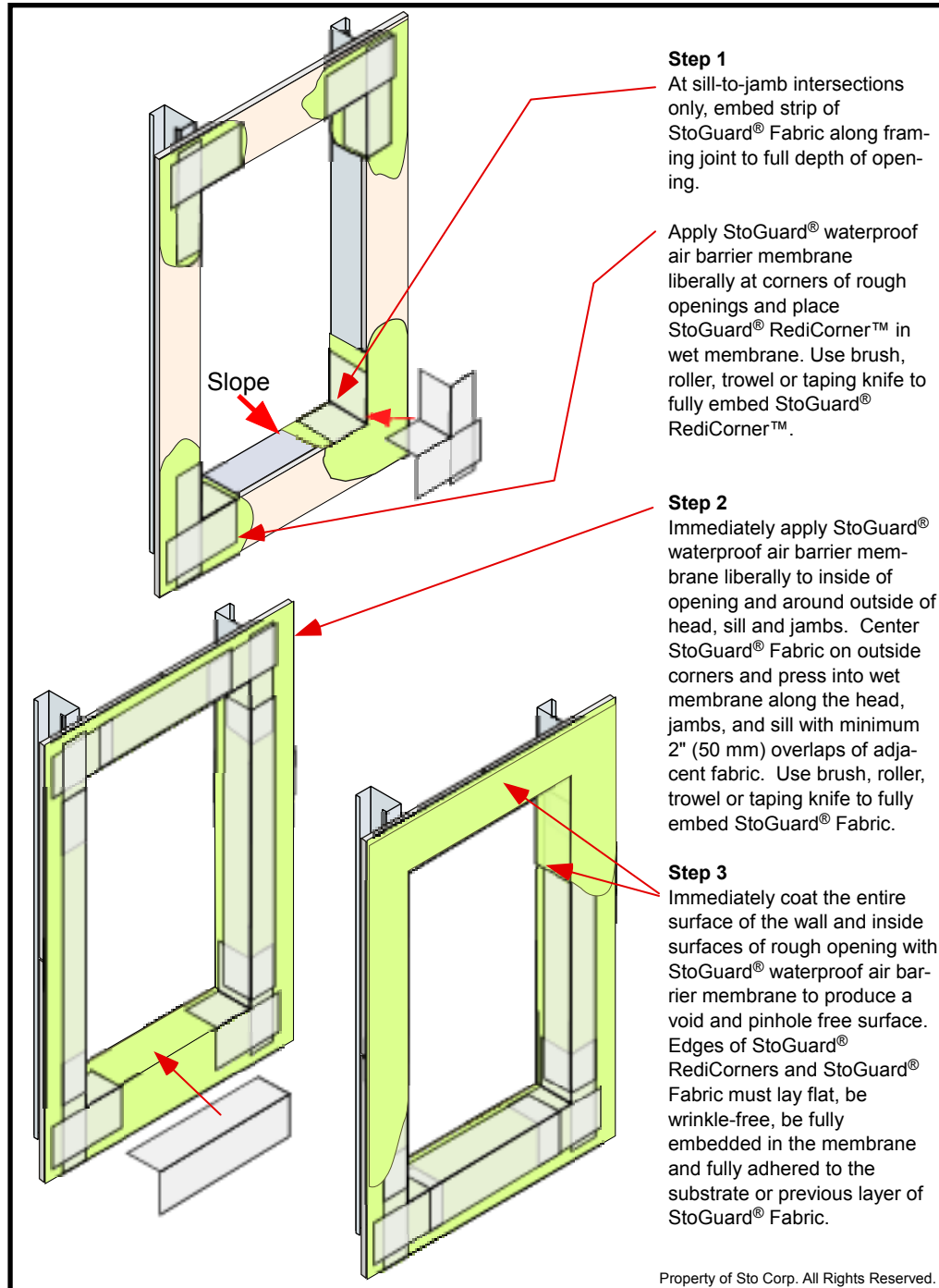
**Step 1**

At sill-to-jamb intersections only, embed strip of StoGuard® Fabric along framing joint to full depth of opening.

Apply StoGuard® waterproof air barrier membrane liberally at corners of rough openings and place StoGuard® RediCorner™ in wet membrane. Use brush, roller, trowel or taping knife to fully embed StoGuard® RediCorner™.

Step 2

Immediately apply StoGuard® waterproof air barrier membrane liberally to inside of opening and around outside of head, sill and jambs. Center StoGuard® Fabric on outside corners and press into wet membrane along the head, jambs, and sill with minimum 2" (50 mm) overlaps of adjacent fabric. Use brush, roller, trowel or taping knife to fully embed StoGuard® Fabric.

Step 3

Immediately coat the entire surface of the wall and inside surfaces of rough opening with StoGuard® waterproof air barrier membrane to produce a void and pinhole free surface. Edges of StoGuard® RediCorners and StoGuard® Fabric must lay flat, be wrinkle-free, be fully embedded in the membrane and fully adhered to the substrate or previous layer of StoGuard® Fabric.

Notes:

- 1] StoGuard waterproof air barrier membrane options:
A) Sto EmeraldCoat®
B) StoGuard VaporSeal™
C) Sto Gold Coat®
(Use with StoTherm NExT EIF systems)
- 2] Prepare opening prior to the installation of the window or mechanical equipment. Provide sill wedge or other means of positive slope to exterior at sill.
- 3] Incorporate flashing as illustrated in 20.23a or as per other details where flashing is shown.
- 4] The complete installation of window or mechanical equipment must include an air seal between the object and the StoGuard protection, inbound of the outer perimeter weather seal.
- 5] See Sto Detail 20.21 for preparation of punched studs used to frame rough openings.
- 6] Refer to Sto specifications and product bulletins for detailed information on substrates and Sto material options. Additional water-resistive barrier/slip sheet required behind some claddings not shown. Refer to Sto Detail 20.00b for additional information.

IMPORTANT: Components not identified as Sto are furnished by other manufacturers and are not necessarily installed by trades who install the Sto products. Refer to project specific contract documents.

Property of Sto Corp. All Rights Reserved.

Attention

www.stocorp.com

Sto products are intended for use by qualified professional contractors, not consumers, as a component of a larger construction assembly as specified by a qualified design professional, general contractor or builder. They should be installed in accordance with those specifications and Sto's instructions. Sto Corp. disclaims all, and assumes no, liability for on-site inspections, for its products applied improperly, or by unqualified persons or entities, or as part of an improperly designed or constructed building, for the nonperformance of adjacent building components or assemblies, or for other construction activities beyond Sto's control. Improper use of Sto products or use as part of an improperly designed or constructed larger assembly or building may result in serious damage to Sto products, and to the structure of the building or its components. **STO CORP. DISCLAIMS ALL WARRANTIES EXPRESS OR IMPLIED EXCEPT FOR EXPLICIT LIMITED WRITTEN WARRANTIES ISSUED TO AND ACCEPTED BY BUILDING OWNERS IN ACCORDANCE WITH STO'S WARRANTY PROGRAMS WHICH ARE SUBJECT TO CHANGE FROM TIME TO TIME.** For the fullest, most current information on proper application, clean-up, mixing and other specifications and warranties, cautions and disclaimers, please refer to the Sto Corp. website, www.stocorp.com.

StoGuard® Waterproof Air Barrier Frame Construction

Rough Opening Protection with StoGuard Fabric and StoGuard Tape at Sill (for abuse-resistance at sill)

Detail No.: 20.20FT

Date: March 2014

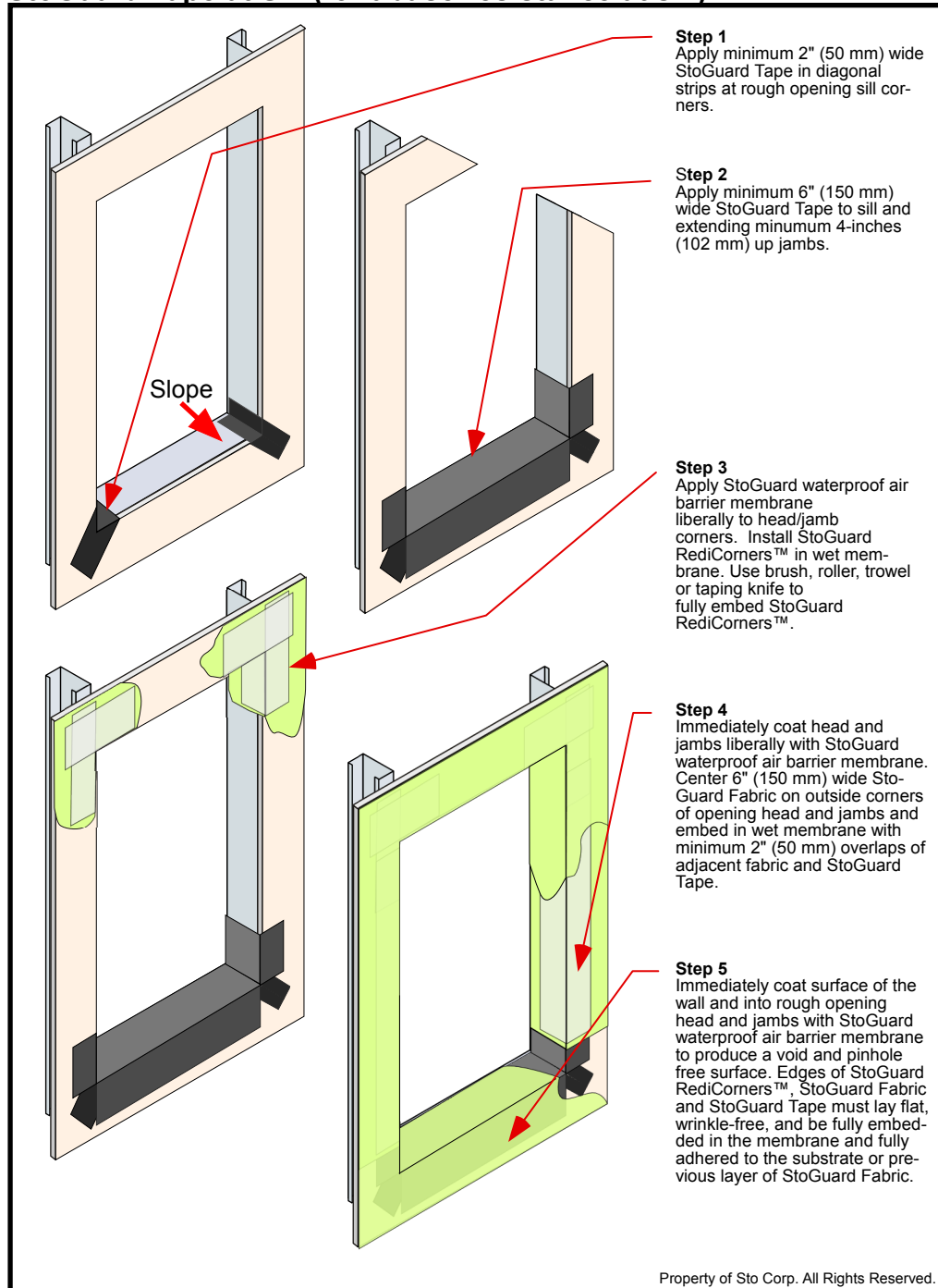

Notes:

- 2) StoGuard waterproof air barrier membrane options:
 - A) Sto EmeraldCoat®
 - B) StoGuard VaporSeal™
 - C) Sto Gold Coat®
 (Use with StoTherm NExT EIF systems)
- 2) Prepare opening prior to the installation of the window or mechanical equipment. Provide sill wedge or other means for positive slope to exterior at sill.
- 3) Incorporate flashing as illustrated in 20.23a or as per other details where flashing is shown.
- 4) The complete installation of window or mechanical equipment must include an air seal between the object and the StoGuard protection, inboard of the outer perimeter weather seal.
- 5) Refer to Sto specifications and product bulletins for detailed information on substrates and Sto material options. Additional water-resistant barrier/slip sheet required behind some claddings not shown. Refer to Sto Detail 20.00b for additional information.

IMPORTANT: Components not identified as Sto are furnished by other manufacturers and are not necessarily installed by trades who install the Sto products. Refer to project specific contract documents.

Attention

Sto products are intended for use by qualified professional contractors, not consumers, as a component of a larger construction assembly as specified by a qualified design professional, general contractor or builder. They should be installed in accordance with those specifications and Sto's instructions. Sto Corp. disclaims all, and assumes no, liability for on-site inspections, for its products applied improperly, or by unqualified persons or entities, or as part of an improperly designed or constructed building, for the nonperformance of adjacent building components or assemblies, or for other construction activities beyond Sto's control. Improper use of Sto products or use as part of an improperly designed or constructed larger assembly or building may result in serious damage to Sto products, and to the structure of the building or its components. **STO CORP. DISCLAIMS ALL WARRANTIES EXPRESS OR IMPLIED EXCEPT FOR EXPLICIT LIMITED WRITTEN WARRANTIES ISSUED TO AND ACCEPTED BY BUILDING OWNERS IN ACCORDANCE WITH STO'S WARRANTY PROGRAMS WHICH ARE SUBJECT TO CHANGE FROM TIME TO TIME.** For the fullest, most current information on proper application, clean-up, mixing and other specifications and warranties, cautions and disclaimers, please refer to the Sto Corp. website, www.stocorp.com.

www.stocorp.com

StoGuard® Waterproof Air Barrier Frame Construction

Rough Opening Protection Sto Gold Fill® and StoGuard® Mesh

Detail No.: 20.20M

Date: March 2014

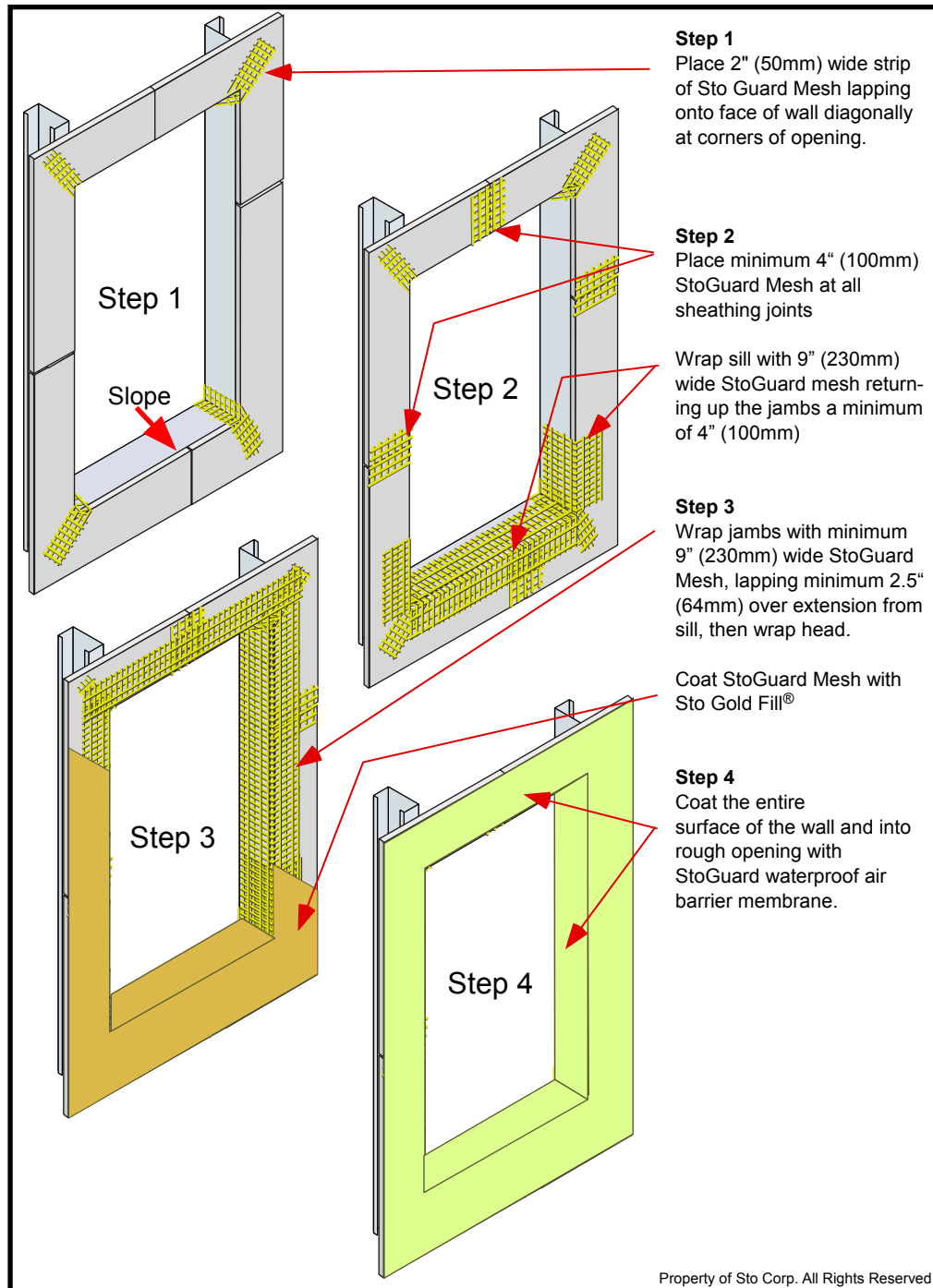

Notes:

- 2] StoGuard waterproof air barrier membrane options:
A) Sto EmeraldCoat®
B) StoGuard VaporSeal™
C) Sto Gold Coat®
(Use with StoTherm NExt EIF systems)
- 2] Prepare opening prior to the installation of the window or mechanical equipment. Provide sill wedge or other means for positive slope to exterior of sill.
- 3] Incorporate flashing as illustrated in 20.23a or as per other details where flashing is shown.
- 4] The complete installation of window or mechanical equipment must include an air seal between the object and the StoGuard protection, inbound of the outer perimeter weather seal.
- 5] Refer to Sto specifications and product bulletins for detailed information on substrates and Sto material options. Additional water-resistive barrier/slip sheet required behind some claddings not shown. Refer to Sto Detail 20.00b for additional information.

IMPORTANT: Components not identified as Sto are furnished by other manufacturers and are not necessarily installed by trades who install the Sto products. Refer to project specific contract documents.

Property of Sto Corp. All Rights Reserved.

Attention

Sto products are intended for use by qualified professional contractors, not consumers, as a component of a larger construction assembly as specified by a qualified design professional, general contractor or builder. They should be installed in accordance with those specifications and Sto's instructions. Sto Corp. disclaims all, and assumes no, liability for on-site inspections, for its products applied improperly, or by unqualified persons or entities, or as part of an improperly designed or constructed building, for the nonperformance of adjacent building components or assemblies, or for other construction activities beyond Sto's control. Improper use of Sto products or use as part of an improperly designed or constructed larger assembly or building may result in serious damage to Sto products, and to the structure of the building or its components. **STO CORP. DISCLAIMS ALL WARRANTIES EXPRESS OR IMPLIED EXCEPT FOR EXPLICIT LIMITED WRITTEN WARRANTIES ISSUED TO AND ACCEPTED BY BUILDING OWNERS IN ACCORDANCE WITH STO'S WARRANTY PROGRAMS WHICH ARE SUBJECT TO CHANGE FROM TIME TO TIME.** For the fullest, most current information on proper application, clean-up, mixing and other specifications and warranties, cautions and disclaimers, please refer to the Sto Corp. website, www.stocorp.com.

www.stocorp.com

StoGuard® Waterproof Air Barrier Frame Construction

Rough Opening Protection with StoGuard® RapidSeal™

Detail No.: 20.20R

Date: March 2014

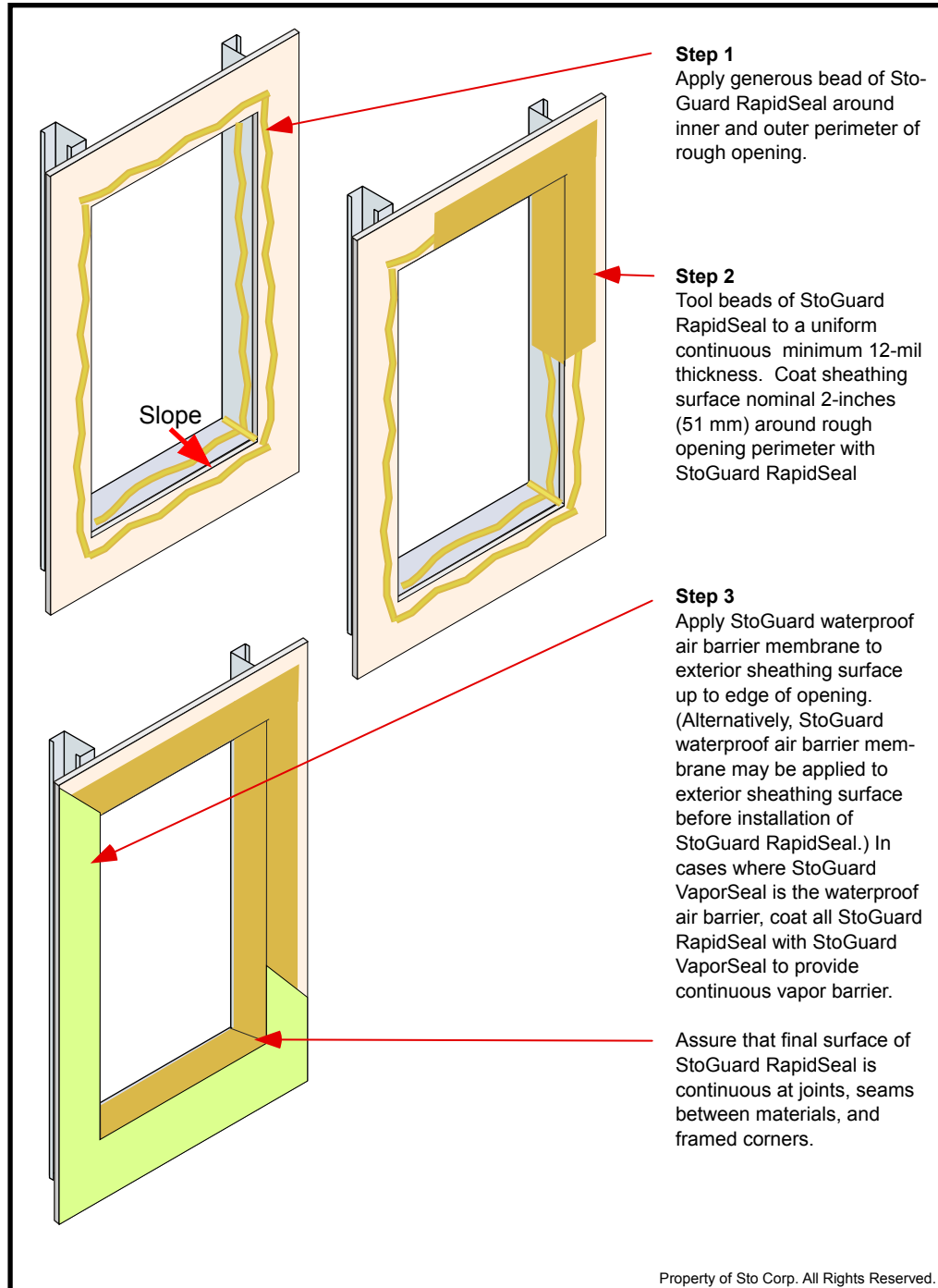

Notes:

- 2] StoGuard waterproof air barrier membrane options:
A) Sto EmeraldCoat®
B) StoGuard VaporSeal™
C) Sto Gold Coat®
(Use with StoTherm NExT EIF systems)
- 2] Prepare opening prior to the installation of the window or mechanical equipment.
- 3] Incorporate flashing as illustrated in 20.23a or as per other details where flashing is shown. Provide sill wedge or other means for positive slope to exterior at sill.
- 4] The complete installation of window or mechanical equipment must include an air seal between the object and the StoGuard protection, inboard of the outer perimeter weather seal.
- 5] Refer to Sto specifications and product bulletins for detailed information on substrates and Sto material options. Additional water-resistive barrier/slip sheet required behind some claddings not shown. Refer to Sto Detail 20.00b for additional information.

IMPORTANT: Components not identified as Sto are furnished by other manufacturers and are not necessarily installed by trades who install the Sto products. Refer to project specific contract documents.

Attention

Sto products are intended for use by qualified professional contractors, not consumers, as a component of a larger construction assembly as specified by a qualified design professional, general contractor or builder. They should be installed in accordance with those specifications and Sto's instructions. Sto Corp. disclaims all, and assumes no, liability for on-site inspections, for its products applied improperly, or by unqualified persons or entities, or as part of an improperly designed or constructed building, for the nonperformance of adjacent building components or assemblies, or for other construction activities beyond Sto's control. Improper use of Sto products or use as part of an improperly designed or constructed larger assembly or building may result in serious damage to Sto products, and to the structure of the building or its components. **STO CORP. DISCLAIMS ALL WARRANTIES EXPRESS OR IMPLIED EXCEPT FOR EXPLICIT LIMITED WRITTEN WARRANTIES ISSUED TO AND ACCEPTED BY BUILDING OWNERS IN ACCORDANCE WITH STO'S WARRANTY PROGRAMS WHICH ARE SUBJECT TO CHANGE FROM TIME TO TIME.** For the fullest, most current information on proper application, clean-up, mixing and other specifications and warranties, cautions and disclaimers, please refer to the Sto Corp. website, www.stocorp.com.

www.stocorp.com

StoGuard® Waterproof Air Barrier Frame Construction Rough Opening Protection with StoGuard Tape

Detail No.: 20.20T

Date: March 2014

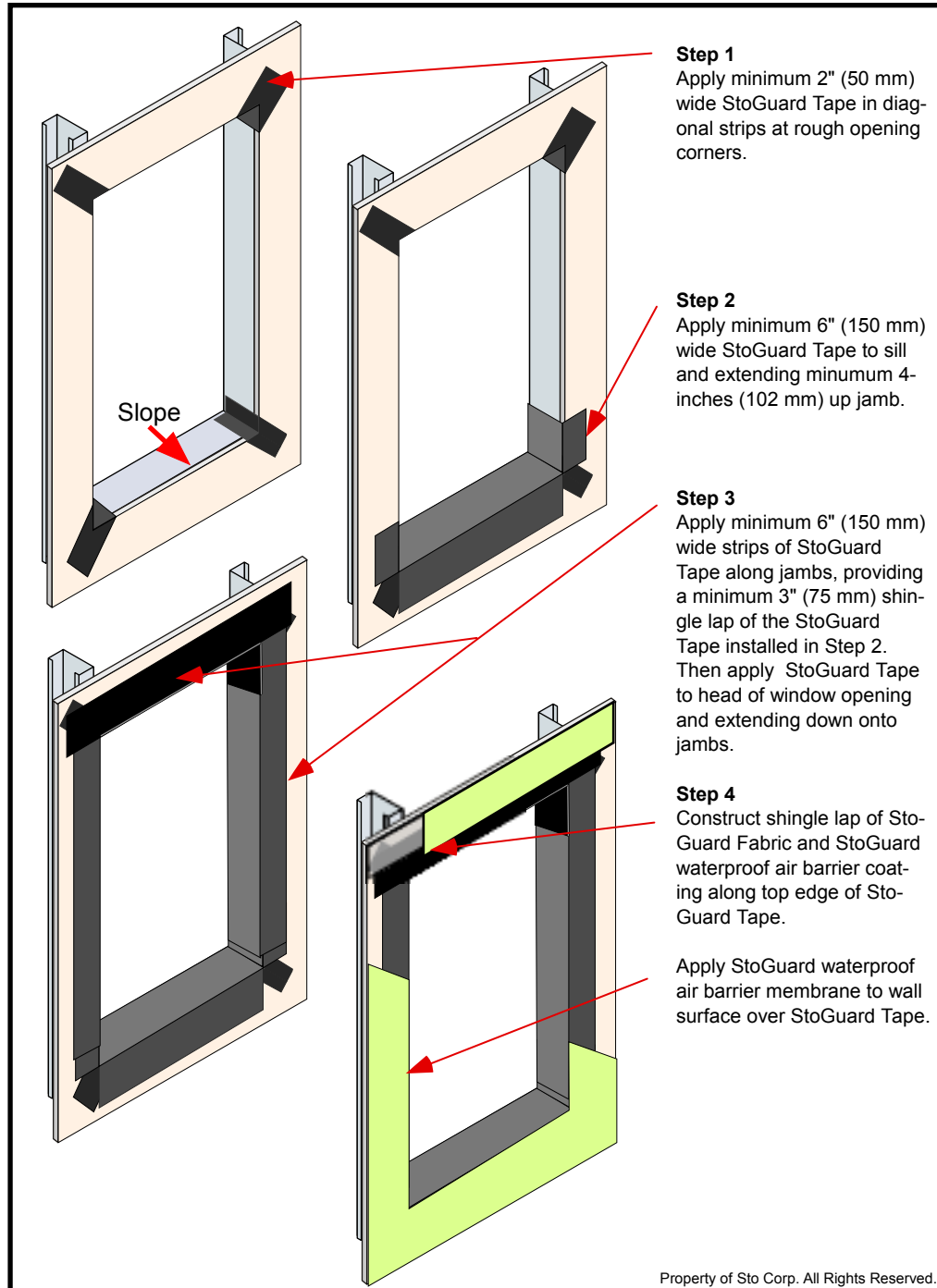

Notes:

- 2] StoGuard waterproof air barrier membrane options:
A) Sto EmeraldCoat®
B) StoGuard VaporSeal™
C) Sto Gold Coat®
(Use with StoTherm NExt EIF systems)
- 2] Prepare opening prior to the installation of the window or mechanical equipment. Provide sill wedge or other means for positive slope to exterior at sill.
- 3] Incorporate flashing as illustrated in 20.23a or as per other details where flashing is shown.
- 4] The complete installation of window or mechanical equipment must include an air seal between the object and the StoGuard protection, inbound of the outer perimeter weather seal.
- 5] Refer to Sto specifications and product bulletins for detailed information on substrates and Sto material options. Additional water-resistive barrier/slip sheet required behind some claddings not shown. Refer to Sto Detail 20.00b for additional information.

IMPORTANT: Components not identified as Sto are furnished by other manufacturers and are not necessarily installed by trades who install the Sto products. Refer to project specific contract documents.

Attention

Sto products are intended for use by qualified professional contractors, not consumers, as a component of a larger construction assembly as specified by a qualified design professional, general contractor or builder. They should be installed in accordance with those specifications and Sto's instructions. Sto Corp. disclaims all, and assumes no, liability for on-site inspections, for its products applied improperly, or by unqualified persons or entities, or as part of an improperly designed or constructed building, for the nonperformance of adjacent building components or assemblies, or for other construction activities beyond Sto's control. Improper use of Sto products or use as part of an improperly designed or constructed larger assembly or building may result in serious damage to Sto products, and to the structure of the building or its components. **STO CORP. DISCLAIMS ALL WARRANTIES EXPRESS OR IMPLIED EXCEPT FOR EXPLICIT LIMITED WRITTEN WARRANTIES ISSUED TO AND ACCEPTED BY BUILDING OWNERS IN ACCORDANCE WITH STO'S WARRANTY PROGRAMS WHICH ARE SUBJECT TO CHANGE FROM TIME TO TIME.** For the fullest, most current information on proper application, clean-up, mixing and other specifications and warranties, cautions and disclaimers, please refer to the Sto Corp. website, www.stocorp.com.

www.stocorp.com

StoGuard® Waterproof Air Barrier Frame Construction

Flashing Integration at Window Opening - Box Window

Detail No.: 20.23a

Date: March 2014

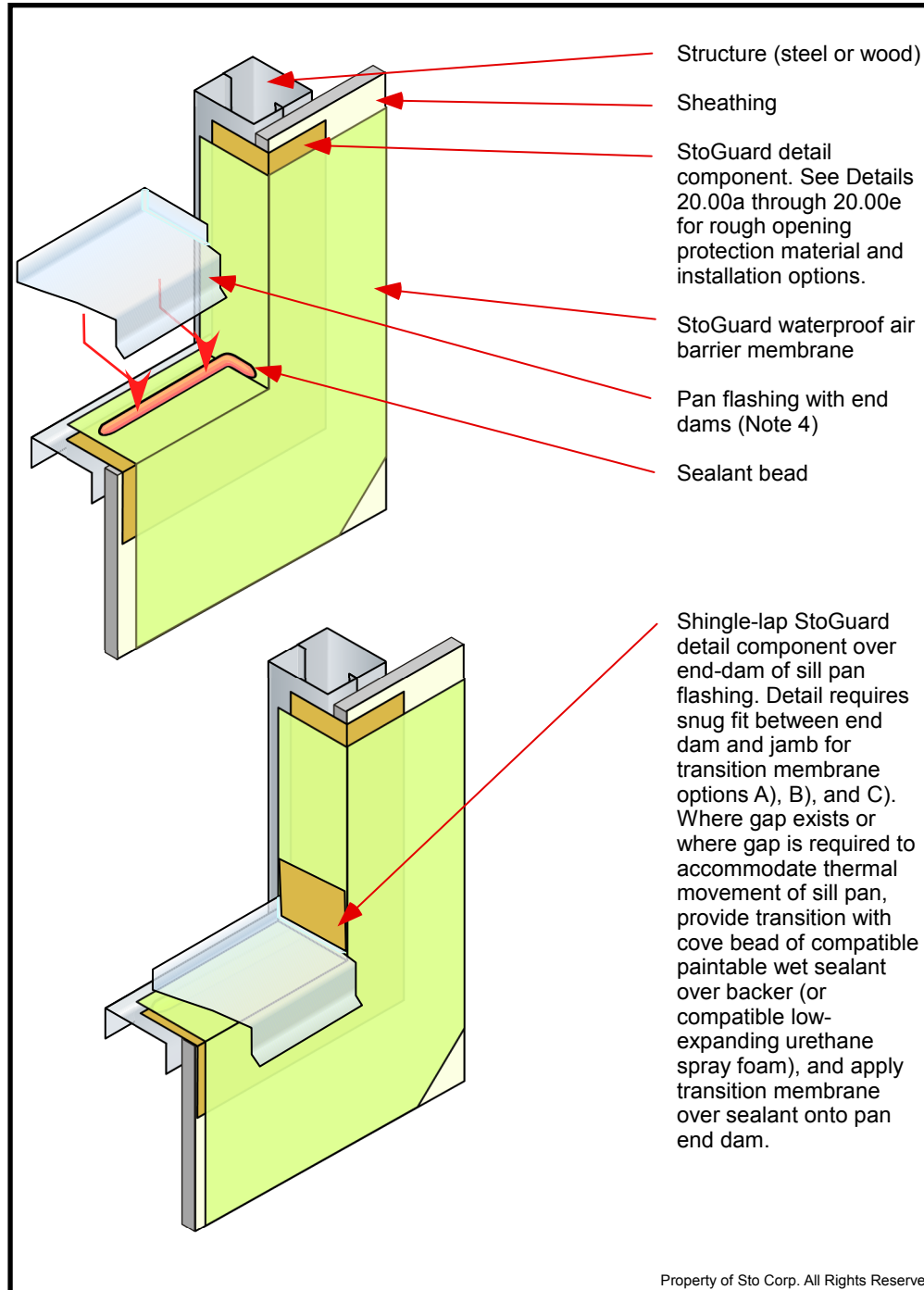

Notes:

- 1] StoGuard detail component options:
A) StoGuard RapidSeal™
B) Sto Gold Fill® with StoGuard Mesh (top coated with StoGuard waterproof air barrier)
C) StoGuard Fabric with StoGuard waterproof air barrier membrane
D) StoGuard Tape (with StoGuard Fabric shingle lap)
- 2] Prepare opening prior to the installation of the window or mechanical equipment. Provide sill wedge or other means of positive slope to exterior at sill.
- 3] Prepare opening prior to the installation of the window or mechanical equipment.
- 4] Provide thermal break as needed in pan flashing design, depending on climate.
- 5] The complete installation of window or mechanical equipment should include an air seal between the object and the StoGuard protection inbound of the outer perimeter weather seal.
- 6] Refer to Sto specifications and product bulletins for detailed information on substrates and Sto material options. Additional water-resistive barrier/slip sheet required behind some claddings not shown. Refer to Sto Detail 20.00b for additional information.

IMPORTANT: Components not identified as Sto are furnished by other manufacturers and are not necessarily installed by trades who install the Sto products. Refer to project specific contract documents.

Property of Sto Corp. All Rights Reserved.

Attention

Sto products are intended for use by qualified professional contractors, not consumers, as a component of a larger construction assembly as specified by a qualified design professional, general contractor or builder. They should be installed in accordance with those specifications and Sto's instructions. Sto Corp. disclaims all, and assumes no, liability for on-site inspections, for its products applied improperly, or by unqualified persons or entities, or as part of an improperly designed or constructed building, for the nonperformance of adjacent building components or assemblies, or for other construction activities beyond Sto's control. Improper use of Sto products or use as part of an improperly designed or constructed larger assembly or building may result in serious damage to Sto products, and to the structure of the building or its components. **STO CORP. DISCLAIMS ALL WARRANTIES EXPRESS OR IMPLIED EXCEPT FOR EXPLICIT LIMITED WRITTEN WARRANTIES ISSUED TO AND ACCEPTED BY BUILDING OWNERS IN ACCORDANCE WITH STO'S WARRANTY PROGRAMS WHICH ARE SUBJECT TO CHANGE FROM TIME TO TIME.** For the fullest, most current information on proper application, clean-up, mixing and other specifications and warranties, cautions and disclaimers, please refer to the Sto Corp. website, www.stocorp.com.

www.stocorp.com

StoGuard® Waterproof Air Barrier Frame Construction Concealed Flashing at Sill - Nail Fin Window

Detail No.: 20.23b

Date: March 2014

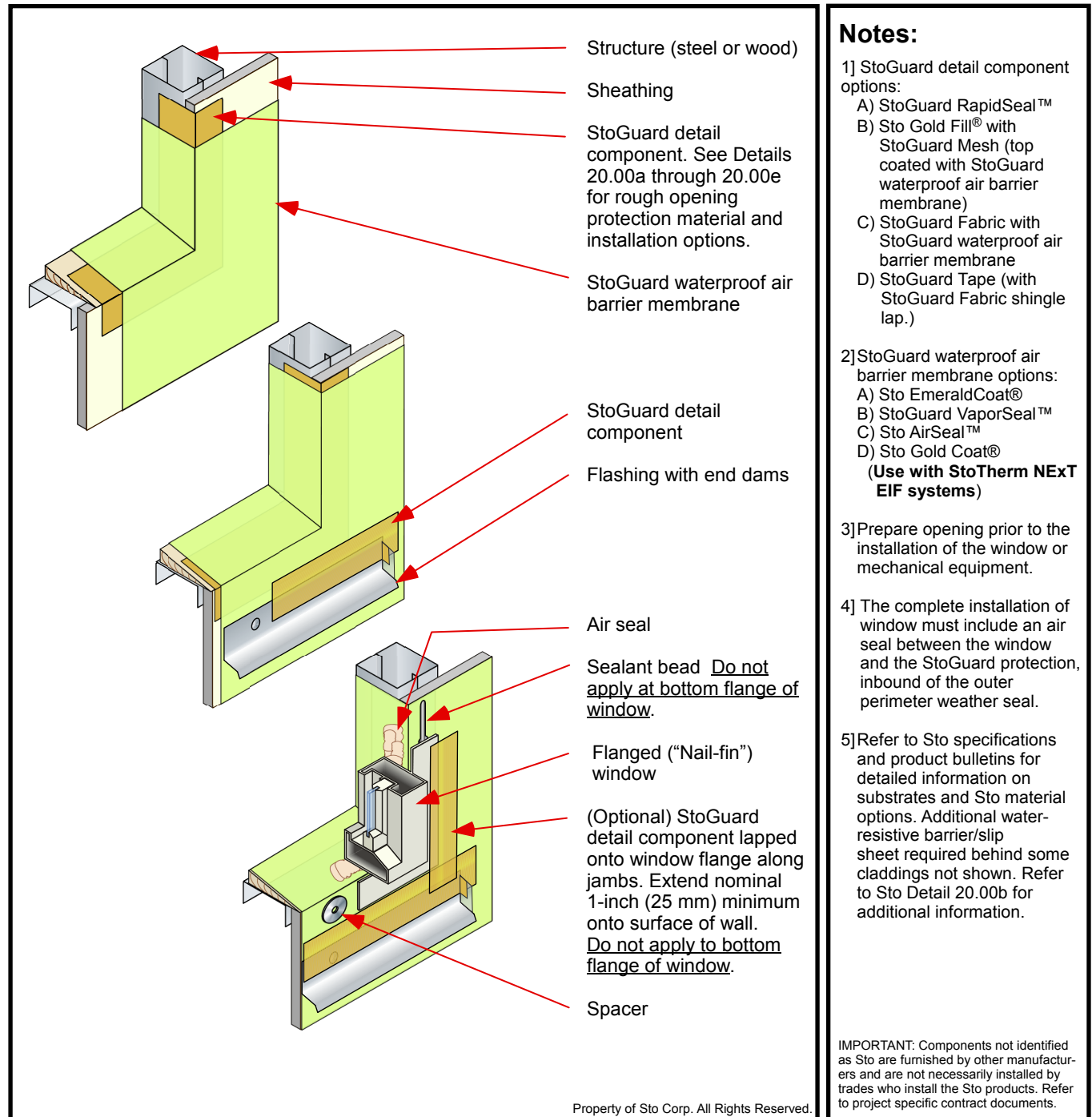

Attention

Sto products are intended for use by qualified professional contractors, not consumers, as a component of a larger construction assembly as specified by a qualified design professional, general contractor or builder. They should be installed in accordance with those specifications and Sto's instructions. Sto Corp. disclaims all, and assumes no, liability for on-site inspections, for its products applied improperly, or by unqualified persons or entities, or as part of an improperly designed or constructed building, for the nonperformance of adjacent building components or assemblies, or for other construction activities beyond Sto's control. Improper use of Sto products or use as part of an improperly designed or constructed larger assembly or building may result in serious damage to Sto products, and to the structure of the building or its components. **STO CORP. DISCLAIMS ALL WARRANTIES EXPRESS OR IMPLIED EXCEPT FOR EXPLICIT LIMITED WRITTEN WARRANTIES ISSUED TO AND ACCEPTED BY BUILDING OWNERS IN ACCORDANCE WITH STO'S WARRANTY PROGRAMS WHICH ARE SUBJECT TO CHANGE FROM TIME TO TIME.** For the fullest, most current information on proper application, clean-up, mixing and other specifications and warranties, cautions and disclaimers, please refer to the Sto Corp. website, www.stocorp.com.

www.stocorp.com

StoGuard® Waterproof Air Barrier Frame Construction Window Head Flashing

Detail No.: 20.24a

Date: March 2014

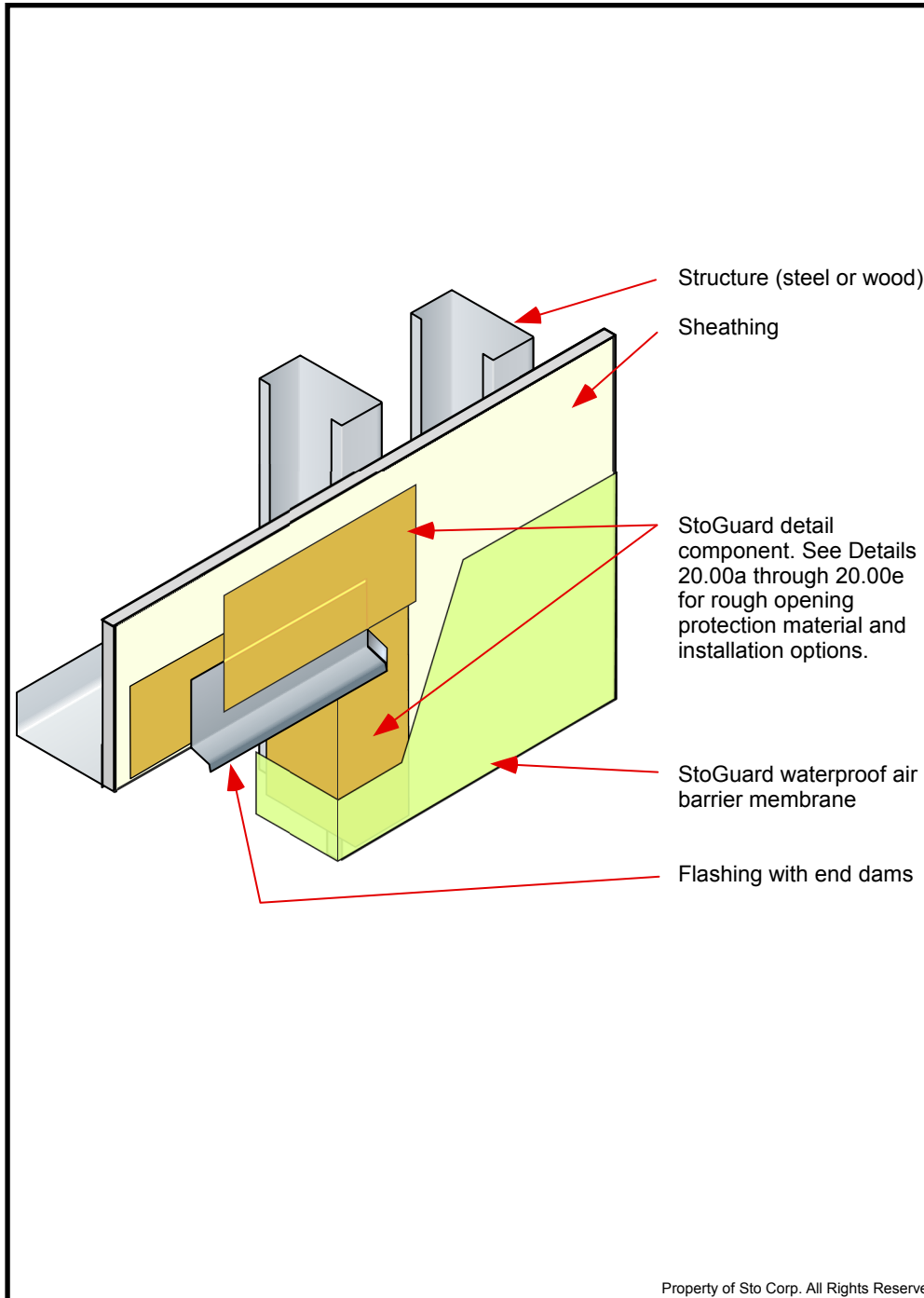

Notes:

- 1] StoGuard detail component options:
 - A) StoGuard RapidSeal™
 - B) Sto Gold Fill® with StoGuard Mesh (top coated with StoGuard waterproof air barrier membrane)
 - C) StoGuard Fabric with StoGuard waterproof air barrier membrane
 - D) StoGuard Tape (with StoGuard Fabric shingle lap)
- 2] StoGuard waterproof air barrier membrane options:
 - A) Sto EmeraldCoat®
 - B) StoGuard VaporSeal™
 - C) Sto AirSeal™
 - D) Sto Gold Coat®
 (Use with StoTherm NExT EIF systems)
- 3] Prepare opening prior to the installation of the window or mechanical equipment.
- 4] The complete installation of window must include an air seal between the window or mechanical equipment and the StoGuard protection, inbound of the outer perimeter weather seal.
- 5] Refer to Sto specifications and product bulletins for detailed information on substrates and Sto material options. Additional water-resistive barrier/slip sheet required behind some claddings not shown. Refer to Sto Detail 20.00b for additional information.

IMPORTANT: Components not identified as Sto are furnished by other manufacturers and are not necessarily installed by trades who install the Sto products. Refer to project specific contract documents.

Property of Sto Corp. All Rights Reserved.

Attention

www.stocorp.com

Sto products are intended for use by qualified professional contractors, not consumers, as a component of a larger construction assembly as specified by a qualified design professional, general contractor or builder. They should be installed in accordance with those specifications and Sto's instructions. Sto Corp. disclaims all, and assumes no, liability for on-site inspections, for its products applied improperly, or by unqualified persons or entities, or as part of an improperly designed or constructed building, for the nonperformance of adjacent building components or assemblies, or for other construction activities beyond Sto's control. Improper use of Sto products or use as part of an improperly designed or constructed larger assembly or building may result in serious damage to Sto products, and to the structure of the building or its components. **STO CORP. DISCLAIMS ALL WARRANTIES EXPRESS OR IMPLIED EXCEPT FOR EXPLICIT LIMITED WRITTEN WARRANTIES ISSUED TO AND ACCEPTED BY BUILDING OWNERS IN ACCORDANCE WITH STO'S WARRANTY PROGRAMS WHICH ARE SUBJECT TO CHANGE FROM TIME TO TIME.** For the fullest, most current information on proper application, clean-up, mixing and other specifications and warranties, cautions and disclaimers, please refer to the Sto Corp. website, www.stocorp.com.

StoGuard® Waterproof Air Barrier Frame Construction Head Flashing with Lintel

Detail No.: 20.24b

Date: March 2014

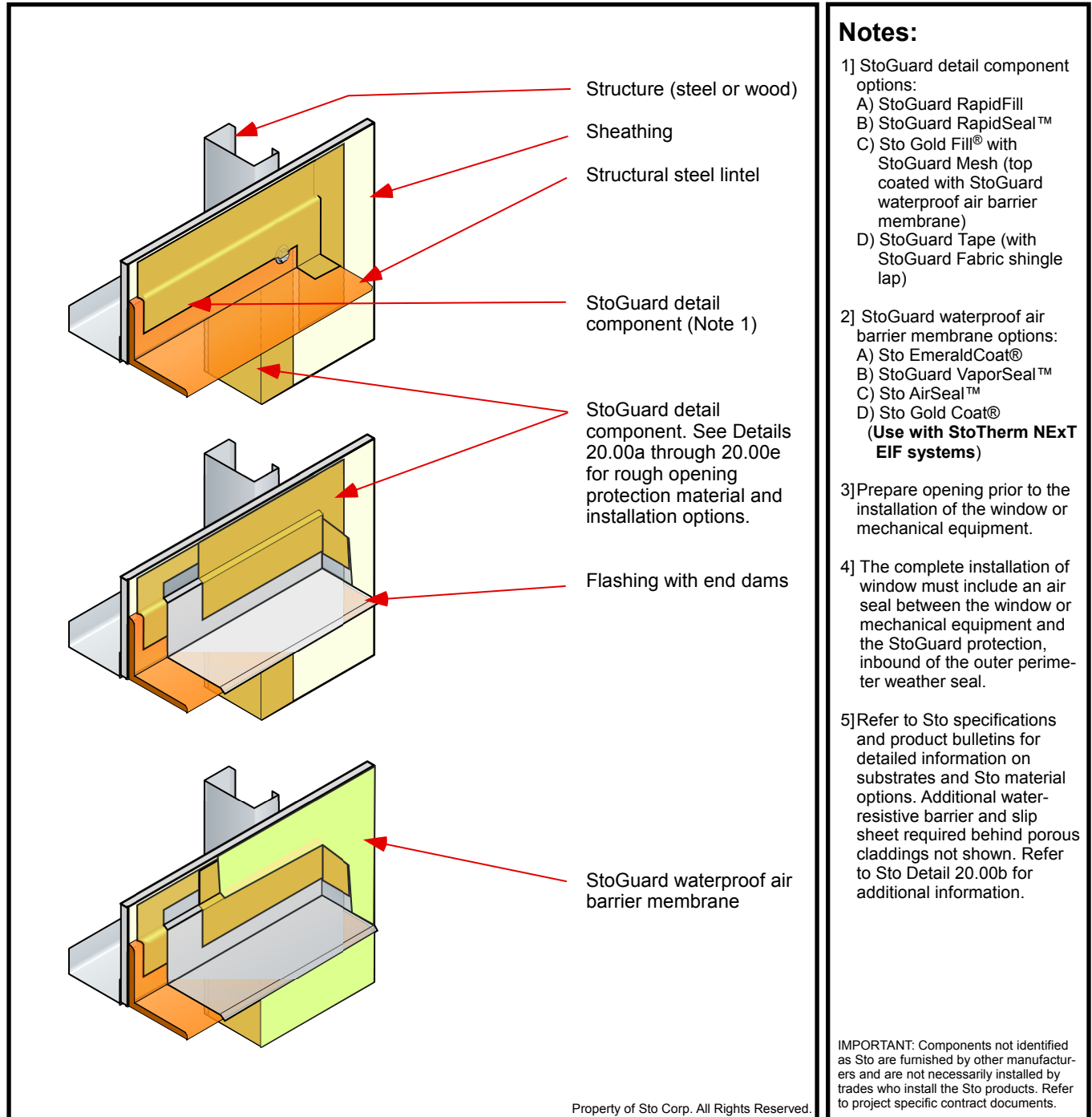

Attention

Sto products are intended for use by qualified professional contractors, not consumers, as a component of a larger construction assembly as specified by a qualified design professional, general contractor or builder. They should be installed in accordance with those specifications and Sto's instructions. Sto Corp. disclaims all, and assumes no, liability for on-site inspections, for its products applied improperly, or by unqualified persons or entities, or as part of an improperly designed or constructed building, for the nonperformance of adjacent building components or assemblies, or for other construction activities beyond Sto's control. Improper use of Sto products or use as part of an improperly designed or constructed larger assembly or building may result in serious damage to Sto products, and to the structure of the building or its components. **STO CORP. DISCLAIMS ALL WARRANTIES EXPRESS OR IMPLIED EXCEPT FOR EXPLICIT LIMITED WRITTEN WARRANTIES ISSUED TO AND ACCEPTED BY BUILDING OWNERS IN ACCORDANCE WITH STO'S WARRANTY PROGRAMS WHICH ARE SUBJECT TO CHANGE FROM TIME TO TIME.** For the fullest, most current information on proper application, clean-up, mixing and other specifications and warranties, cautions and disclaimers, please refer to the Sto Corp. website, www.stocorp.com.

www.stocorp.com

StoGuard® Waterproof Air Barrier Frame Construction

Detail No.: 20.30a

Balcony Floor to Wall Transition with Deck Coating

Date: March 2014

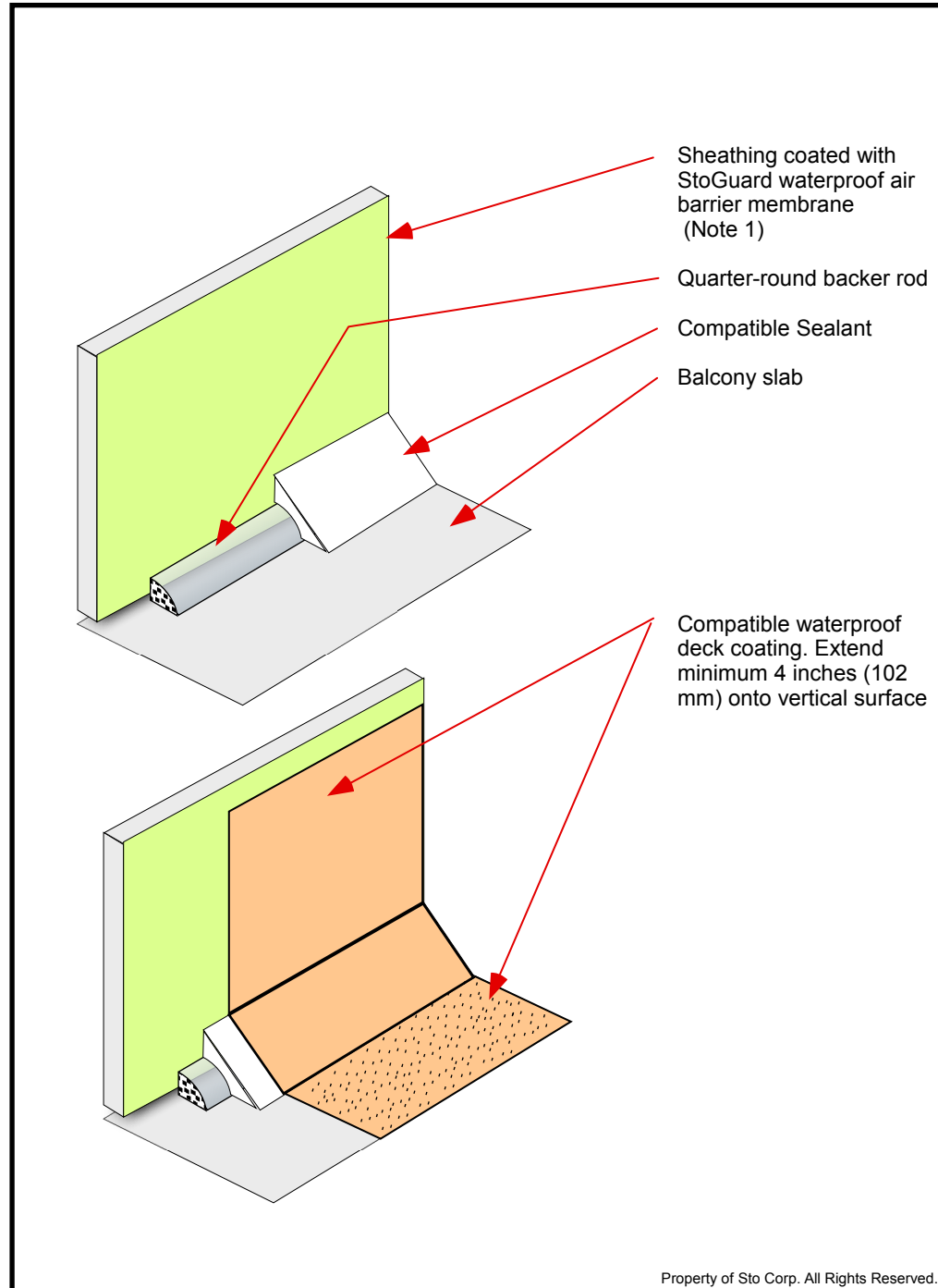

Notes:

- 1] StoGuard waterproof air barrier membrane options:
 A) Sto EmeraldCoat®
 B) StoGuard VaporSeal™
 C) Sto AirSeal™
 D) Sto Gold Coat®
 (Use with StoTherm NExT EIF systems)
- 2] Provide positive slope to direct water away from wall. Verify compatibility of waterproof deck membrane materials with StoGuard waterproof air barrier membrane.
- 3] Refer to Sto specifications and product bulletins for detailed information on substrates and Sto material options. Additional water-resistive barrier/slip sheet required behind some claddings not shown. Refer to Sto Detail 20.00b for additional information.

IMPORTANT: Components not identified as Sto are furnished by other manufacturers and are not necessarily installed by trades who install the Sto products. Refer to project specific contract documents.

Property of Sto Corp. All Rights Reserved.

Attention

www.stocorp.com

Sto products are intended for use by qualified professional contractors, not consumers, as a component of a larger construction assembly as specified by a qualified design professional, general contractor or builder. They should be installed in accordance with those specifications and Sto's instructions. Sto Corp. disclaims all, and assumes no, liability for on-site inspections, for its products applied improperly, or by unqualified persons or entities, or as part of an improperly designed or constructed building, for the nonperformance of adjacent building components or assemblies, or for other construction activities beyond Sto's control. Improper use of Sto products or use as part of an improperly designed or constructed larger assembly or building may result in serious damage to Sto products, and to the structure of the building or its components. **STO CORP. DISCLAIMS ALL WARRANTIES EXPRESS OR IMPLIED EXCEPT FOR EXPLICIT LIMITED WRITTEN WARRANTIES ISSUED TO AND ACCEPTED BY BUILDING OWNERS IN ACCORDANCE WITH STO'S WARRANTY PROGRAMS WHICH ARE SUBJECT TO CHANGE FROM TIME TO TIME.** For the fullest, most current information on proper application, clean-up, mixing and other specifications and warranties, cautions and disclaimers, please refer to the Sto Corp. website, www.stocorp.com.

StoGuard® Waterproof Air Barrier Frame Construction

Balcony Floor to Wall Transition - Inside and Outside Corners

Detail No.: 20.30b

Date: March 2014

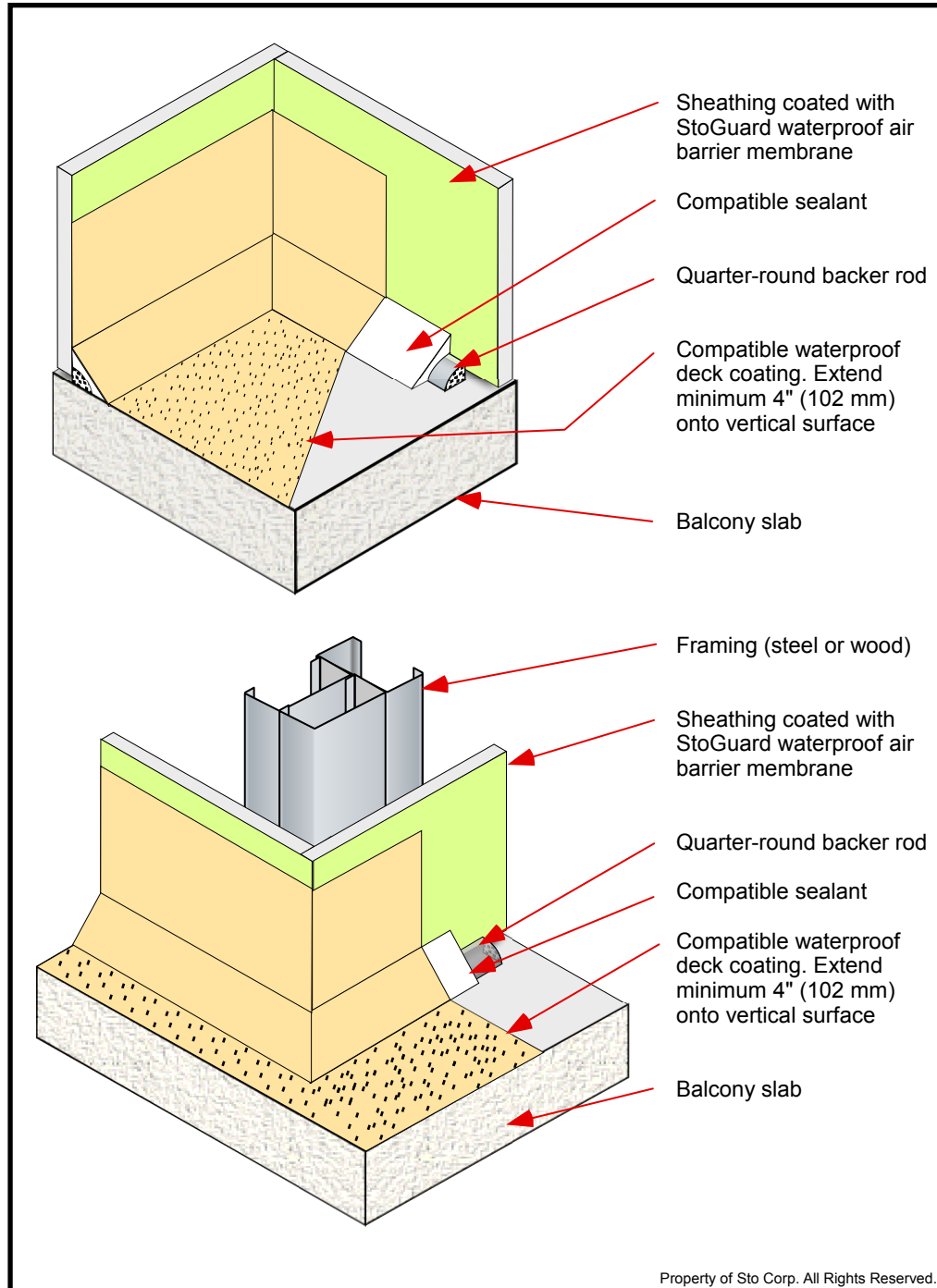

Notes:

- 1] StoGuard waterproof air barrier membrane options:
A) Sto EmeraldCoat®
B) StoGuard VaporSeal™
C) Sto AirSeal™
D) Sto Gold Coat®
(Use with StoTherm NExT EIF systems)
- 2] Provide positive slope to direct water away from wall. Verify compatibility of balcony waterproofing materials with StoGuard waterproof air barrier membrane
- 3] Refer to Sto specifications and product bulletins for detailed information on substrates and Sto material options. Additional water-resistive barrier/slip sheet required behind some claddings not shown. Refer to Sto Detail 20.00b for additional information.

IMPORTANT: Components not identified as Sto are furnished by other manufacturers and are not necessarily installed by trades who install the Sto products. Refer to project specific contract documents.

Property of Sto Corp. All Rights Reserved.

Attention

www.stocorp.com

Sto products are intended for use by qualified professional contractors, not consumers, as a component of a larger construction assembly as specified by a qualified design professional, general contractor or builder. They should be installed in accordance with those specifications and Sto's instructions. Sto Corp. disclaims all, and assumes no, liability for on-site inspections, for its products applied improperly, or by unqualified persons or entities, or as part of an improperly designed or constructed building, for the nonperformance of adjacent building components or assemblies, or for other construction activities beyond Sto's control. Improper use of Sto products or use as part of an improperly designed or constructed larger assembly or building may result in serious damage to Sto products, and to the structure of the building or its components. **STO CORP. DISCLAIMS ALL WARRANTIES EXPRESS OR IMPLIED EXCEPT FOR EXPLICIT LIMITED WRITTEN WARRANTIES ISSUED TO AND ACCEPTED BY BUILDING OWNERS IN ACCORDANCE WITH STO'S WARRANTY PROGRAMS WHICH ARE SUBJECT TO CHANGE FROM TIME TO TIME.** For the fullest, most current information on proper application, clean-up, mixing and other specifications and warranties, cautions and disclaimers, please refer to the Sto Corp. website, www.stocorp.com.

StoGuard® Waterproof Air Barrier Frame Construction Deck Connection

Detail No.: 20.32

Date: March 2014

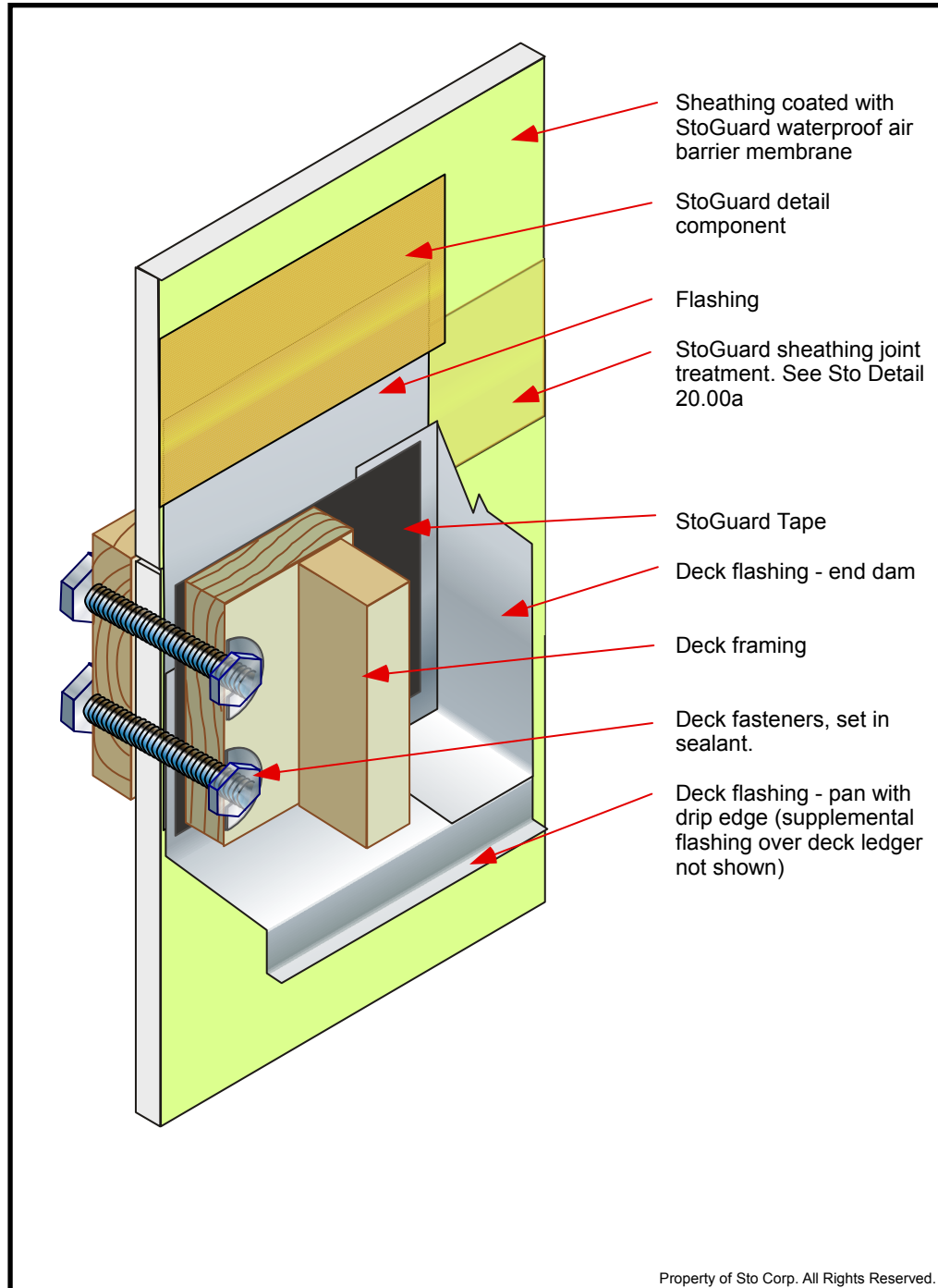

Notes:

- 1] StoGuard detail component options:
 - A) StoGuard RapidFill
 - B) StoGuard RapidSeal™
 - C) Sto Gold Fill® with StoGuard Mesh (top coated with StoGuard waterproof air barrier membrane).
 - D) StoGuard Fabric with StoGuard waterproof air barrier membrane
 - E) StoGuard Tape (with StoGuard Fabric shingle lap).
- 2] StoGuard waterproof air barrier membrane options:
 - A) Sto EmeraldCoat®
 - B) StoGuard VaporSeal™
 - C) Sto AirSeal™
 - D) Sto Gold Coat®

(Use with StoTherm NExT EIF systems)
- 3] Refer to Sto specifications and product bulletins for detailed information on substrates and Sto material options. Additional water-resistant barrier/slip sheet required behind some claddings not shown. Refer to Sto Detail 20.00b for additional information.

IMPORTANT: Components not identified as Sto are furnished by other manufacturers and are not necessarily installed by trades who install the Sto products. Refer to project specific contract documents.

Attention

Sto products are intended for use by qualified professional contractors, not consumers, as a component of a larger construction assembly as specified by a qualified design professional, general contractor or builder. They should be installed in accordance with those specifications and Sto's instructions. Sto Corp. disclaims all, and assumes no, liability for on-site inspections, for its products applied improperly, or by unqualified persons or entities, or as part of an improperly designed or constructed building, for the nonperformance of adjacent building components or assemblies, or for other construction activities beyond Sto's control. Improper use of Sto products or use as part of an improperly designed or constructed larger assembly or building may result in serious damage to Sto products, and to the structure of the building or its components. **STO CORP. DISCLAIMS ALL WARRANTIES EXPRESS OR IMPLIED EXCEPT FOR EXPLICIT LIMITED WRITTEN WARRANTIES ISSUED TO AND ACCEPTED BY BUILDING OWNERS IN ACCORDANCE WITH STO'S WARRANTY PROGRAMS WHICH ARE SUBJECT TO CHANGE FROM TIME TO TIME.** For the fullest, most current information on proper application, clean-up, mixing and other specifications and warranties, cautions and disclaimers, please refer to the Sto Corp. website, www.stocorp.com.

www.stocorp.com

StoGuard® Waterproof Air Barrier Frame Construction

Detail No.: 20.51a

Floor Line Flashing at Fixed Slab-to-Frame Condition

Date: March 2014

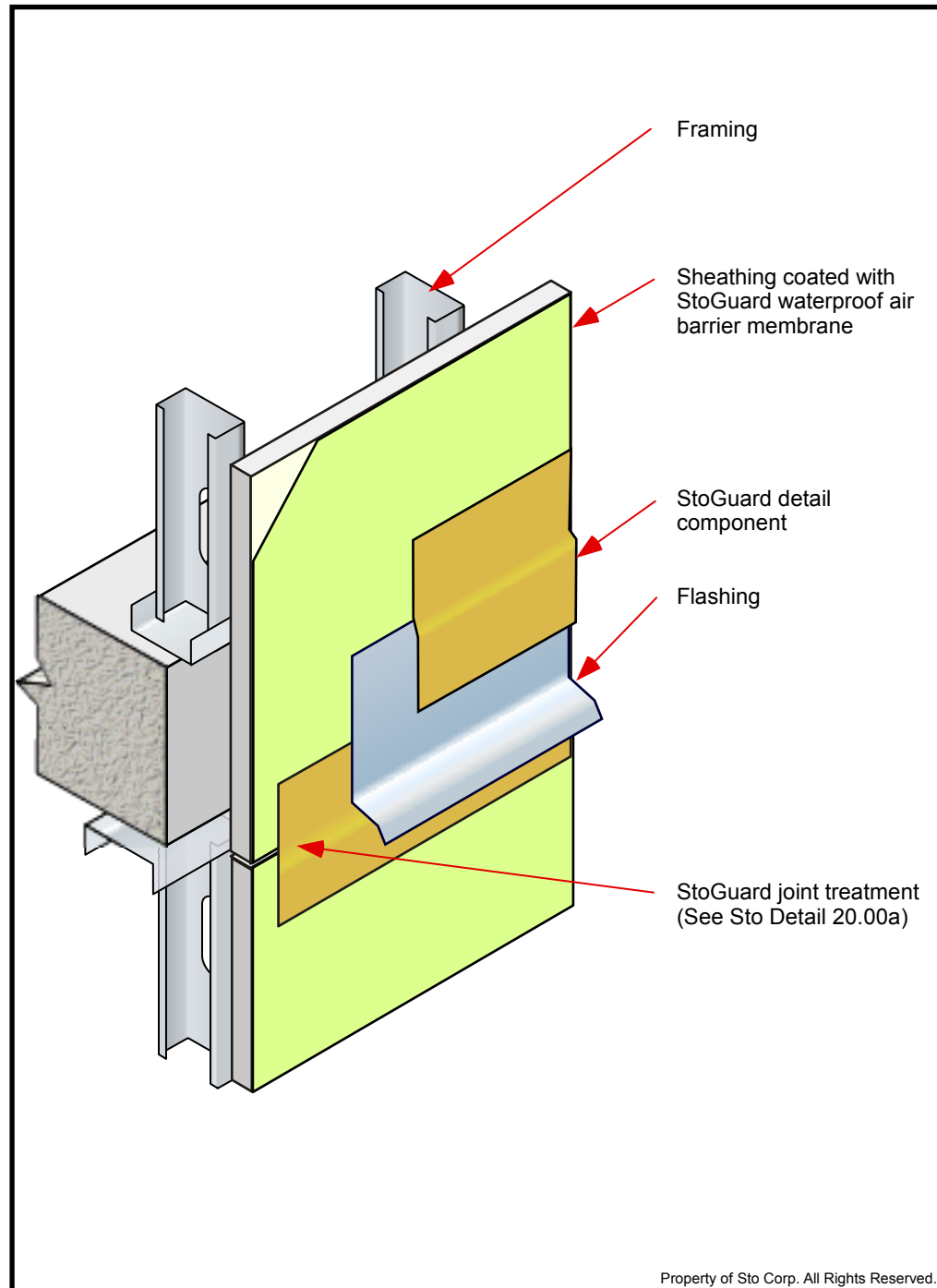

Notes:

- 1) StoGuard detail component options:
 - A) StoGuard RapidFill
 - B) StoGuard RapidSeal™
 - C) Sto Gold Fill® with StoGuard Mesh (top coated with StoGuard waterproof air barrier membrane)
 - D) StoGuard Fabric with StoGuard waterproof air barrier membrane
 - E) StoGuard Tape (with StoGuard Fabric shingle lap)
- 2) StoGuard waterproof air barrier membrane options:
 - A) Sto EmeraldCoat®
 - B) StoGuard VaporSeal™
 - C) Sto AirSeal™
 - D) Sto Gold Coat®

(Use with StoTherm NExT EIF systems)
- 3) StoGuard joint treatment options:
 - A) StoGuard RapidFill
 - B) Sto Gold Fill® with StoGuard Mesh joints ≤ 1/8" (3 mm) wide
 - C) StoGuard Fabric with StoGuard waterproof air barrier membrane joints ≤ 1/8" (3 mm) wide
 - D) StoGuard RapidSeal™ with StoGuard Mesh - joints ≤ 1/4" (6 mm) wide
- 4) Refer to Sto specifications and product bulletins for detailed information on substrates and Sto material options. Additional water-resistive barrier/slip sheet required behind some claddings not shown. Refer to Sto Detail 20.00b for additional information.

IMPORTANT: Components not identified as Sto are furnished by other manufacturers and are not necessarily installed by trades who install the Sto products. Refer to project specific contract documents.

Property of Sto Corp. All Rights Reserved.

Attention

www.stocorp.com

Sto products are intended for use by qualified professional contractors, not consumers, as a component of a larger construction assembly as specified by a qualified design professional, general contractor or builder. They should be installed in accordance with those specifications and Sto's instructions. Sto Corp. disclaims all, and assumes no, liability for on-site inspections, for its products applied improperly, or by unqualified persons or entities, or as part of an improperly designed or constructed building, for the nonperformance of adjacent building components or assemblies, or for other construction activities beyond Sto's control. Improper use of Sto products or use as part of an improperly designed or constructed larger assembly or building may result in serious damage to Sto products, and to the structure of the building or its components. **STO CORP. DISCLAIMS ALL WARRANTIES EXPRESS OR IMPLIED EXCEPT FOR EXPLICIT LIMITED WRITTEN WARRANTIES ISSUED TO AND ACCEPTED BY BUILDING OWNERS IN ACCORDANCE WITH STO'S WARRANTY PROGRAMS WHICH ARE SUBJECT TO CHANGE FROM TIME TO TIME.** For the fullest, most current information on proper application, clean-up, mixing and other specifications and warranties, cautions and disclaimers, please refer to the Sto Corp. website, www.stocorp.com.

StoGuard® Waterproof Air Barrier Frame Construction Floor Line with Deflection Track

Detail No.: 20.51b

Date: March 2014

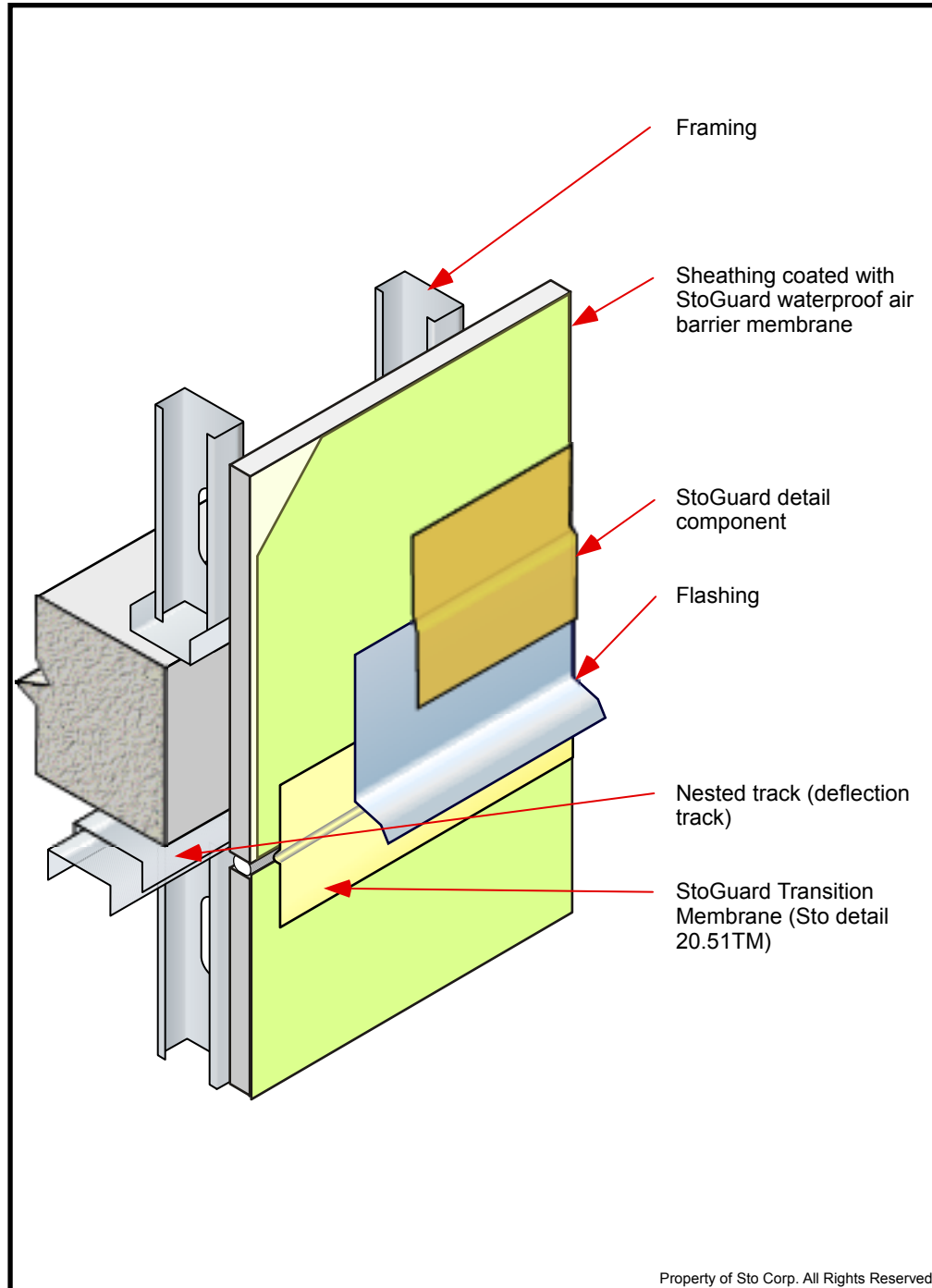

Notes:

- 1] StoGuard detail component options:
 - A) StoGuard RapidFill
 - B) StoGuard RapidSeal™
 - C) Sto Gold Fill® with StoGuard Mesh (top coated with StoGuard waterproof air barrier membrane)
 - D) StoGuard Fabric with StoGuard waterproof air barrier membrane
 - E) StoGuard Tape (with StoGuard Fabric shingle lap)
- 2] StoGuard waterproof air barrier membrane options:
 - A) Sto EmeraldCoat®
 - B) StoGuard VaporSeal™
 - C) Sto AirSeal™
 - D) Sto Gold Coat®

(Use with StoTherm NExT EIF systems)
- 3] Refer to Sto specifications and product bulletins for detailed information on substrates and Sto material options. Additional water-resistive barrier/slip sheet required behind some claddings not shown. Refer to Sto Detail 20.00b for additional information.

IMPORTANT: Components not identified as Sto are furnished by other manufacturers and are not necessarily installed by trades who install the Sto products. Refer to project specific contract documents.

Attention

www.stocorp.com

Sto products are intended for use by qualified professional contractors, not consumers, as a component of a larger construction assembly as specified by a qualified design professional, general contractor or builder. They should be installed in accordance with those specifications and Sto's instructions. Sto Corp. disclaims all, and assumes no, liability for on-site inspections, for its products applied improperly, or by unqualified persons or entities, or as part of an improperly designed or constructed building, for the nonperformance of adjacent building components or assemblies, or for other construction activities beyond Sto's control. Improper use of Sto products or use as part of an improperly designed or constructed larger assembly or building may result in serious damage to Sto products, and to the structure of the building or its components. **STO CORP. DISCLAIMS ALL WARRANTIES EXPRESS OR IMPLIED EXCEPT FOR EXPLICIT LIMITED WRITTEN WARRANTIES ISSUED TO AND ACCEPTED BY BUILDING OWNERS IN ACCORDANCE WITH STO'S WARRANTY PROGRAMS WHICH ARE SUBJECT TO CHANGE FROM TIME TO TIME.** For the fullest, most current information on proper application, clean-up, mixing and other specifications and warranties, cautions and disclaimers, please refer to the Sto Corp. website, www.stocorp.com.

StoGuard® Waterproof Air Barrier Frame Construction Shelf Angle at Floor Line

Detail No.: 20.51c

Date: March 2014

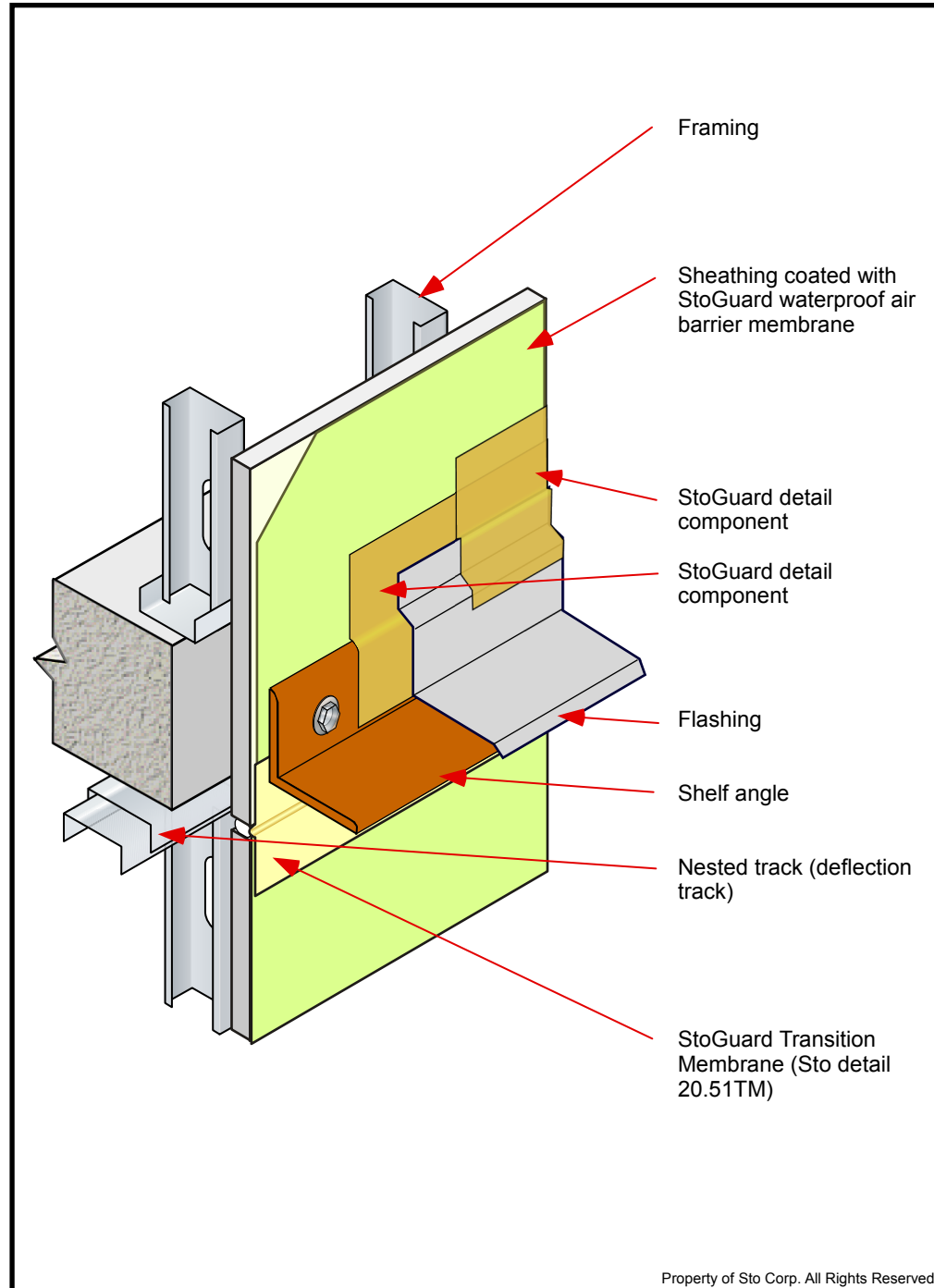

Notes:

- 1) StoGuard detail component options:
 - A) StoGuard RapidFill
 - B) StoGuard RapidSeal™
 - C) Sto Gold Fill® with StoGuard Mesh (top coated with StoGuard waterproof air barrier membrane)
 - D) StoGuard Tape (with StoGuard Fabric shingle lap)
- 2) StoGuard waterproof air barrier membrane options:
 - A) Sto EmeraldCoat®
 - B) StoGuard VaporSeal™
 - C) Sto AirSeal™
 - D) Sto Gold Coat®

(Use with StoTherm NExT EIF systems)
- 3) Refer to Sto specifications and product bulletins for detailed information on substrates and Sto material options. Additional water-resistant barrier/slip sheet required behind some claddings not shown. Refer to Sto Detail 20.00b for additional information.

IMPORTANT: Components not identified as Sto are furnished by other manufacturers and are not necessarily installed by trades who install the Sto products. Refer to project specific contract documents.

Property of Sto Corp. All Rights Reserved.

Attention

www.stocorp.com

Sto products are intended for use by qualified professional contractors, not consumers, as a component of a larger construction assembly as specified by a qualified design professional, general contractor or builder. They should be installed in accordance with those specifications and Sto's instructions. Sto Corp. disclaims all, and assumes no, liability for on-site inspections, for its products applied improperly, or by unqualified persons or entities, or as part of an improperly designed or constructed building, for the nonperformance of adjacent building components or assemblies, or for other construction activities beyond Sto's control. Improper use of Sto products or use as part of an improperly designed or constructed larger assembly or building may result in serious damage to Sto products, and to the structure of the building or its components. **STO CORP. DISCLAIMS ALL WARRANTIES EXPRESS OR IMPLIED EXCEPT FOR EXPLICIT LIMITED WRITTEN WARRANTIES ISSUED TO AND ACCEPTED BY BUILDING OWNERS IN ACCORDANCE WITH STO'S WARRANTY PROGRAMS WHICH ARE SUBJECT TO CHANGE FROM TIME TO TIME.** For the fullest, most current information on proper application, clean-up, mixing and other specifications and warranties, cautions and disclaimers, please refer to the Sto Corp. website, www.stocorp.com.

StoGuard® Waterproof Air Barrier Frame Construction

Vertical Through-Wall Expansion Joint with Wet Sealant

Detail No.: 20.52b

Date: March 2014

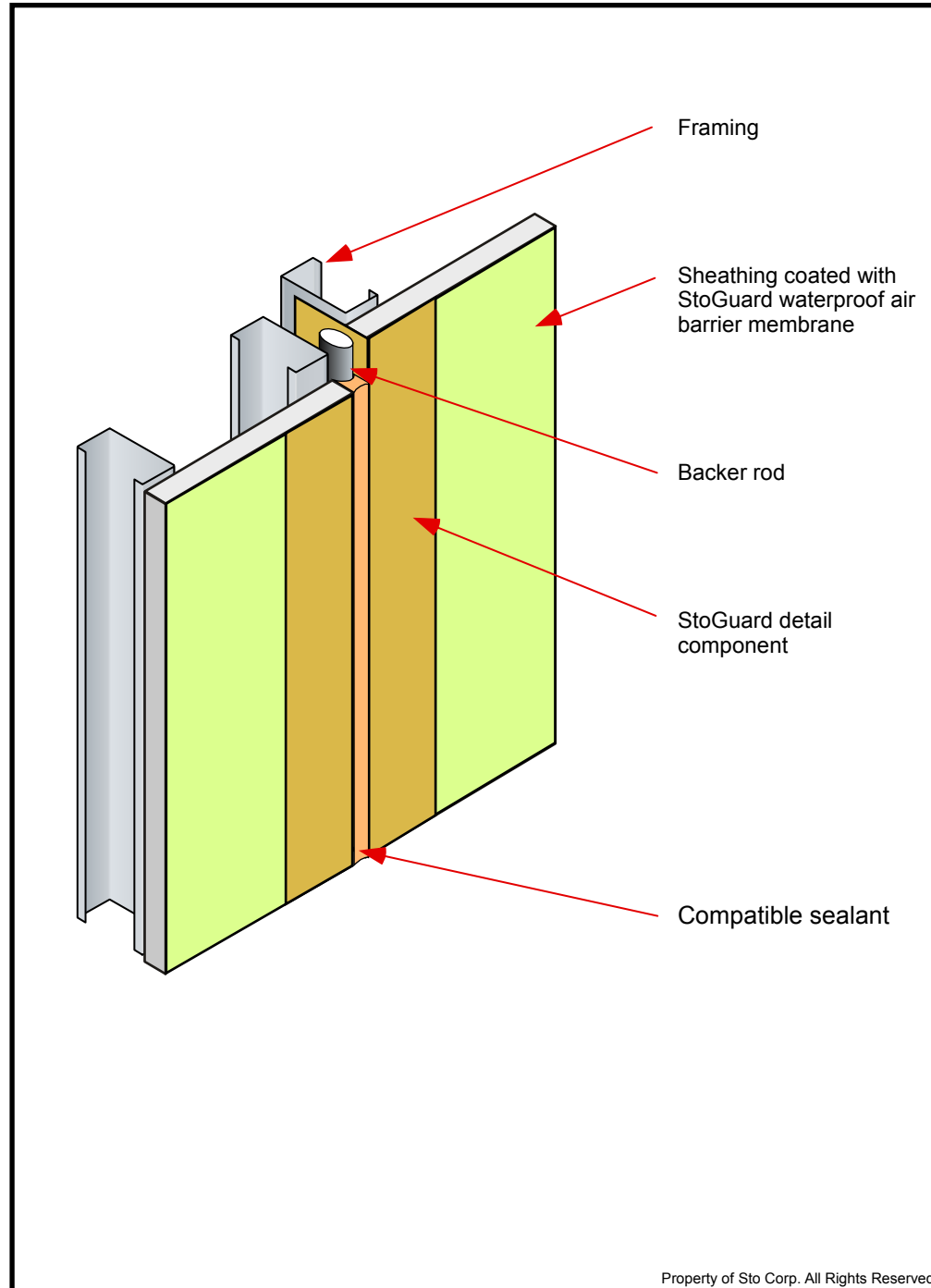

Notes:

- 1) StoGuard detail component options:
 A) StoGuard RapidFill
 B) StoGuard RapidSeal™
 C) Sto Gold Fill StoGuard Mesh top coated with StoGuard waterproof air barrier membrane.
- 2) StoGuard waterproof air barrier membrane options:
 A) Sto EmeraldCoat®
 B) StoGuard VaporSeal™
 C) Sto AirSeal™
 D) Sto Gold Coat®
 (Use with StoTherm NExT EIF systems)
- 3) Specify a compatible sealant material that meets the movement requirements of the joint as defined by the joint sealant supplier.
- 4) Refer to Sto specifications and product bulletins for detailed information on substrates and Sto material options. Additional water-resistive barrier/slip sheet required behind some claddings not shown. Refer to Sto Detail 20.00b for additional information.

IMPORTANT: Components not identified as Sto are furnished by other manufacturers and are not necessarily installed by trades who install the Sto products. Refer to project specific contract documents.

Property of Sto Corp. All Rights Reserved.

Attention

www.stocorp.com

Sto products are intended for use by qualified professional contractors, not consumers, as a component of a larger construction assembly as specified by a qualified design professional, general contractor or builder. They should be installed in accordance with those specifications and Sto's instructions. Sto Corp. disclaims all, and assumes no, liability for on-site inspections, for its products applied improperly, or by unqualified persons or entities, or as part of an improperly designed or constructed building, for the nonperformance of adjacent building components or assemblies, or for other construction activities beyond Sto's control. Improper use of Sto products or use as part of an improperly designed or constructed larger assembly or building may result in serious damage to Sto products, and to the structure of the building or its components. **STO CORP. DISCLAIMS ALL WARRANTIES EXPRESS OR IMPLIED EXCEPT FOR EXPLICIT LIMITED WRITTEN WARRANTIES ISSUED TO AND ACCEPTED BY BUILDING OWNERS IN ACCORDANCE WITH STO'S WARRANTY PROGRAMS WHICH ARE SUBJECT TO CHANGE FROM TIME TO TIME.** For the fullest, most current information on proper application, clean-up, mixing and other specifications and warranties, cautions and disclaimers, please refer to the Sto Corp. website, www.stocorp.com.

StoGuard® Waterproof Air Barrier Frame Construction

Inside Corner - Dissimilar Substrates

(Fixed Frame Pilaster or Similar Condition)

Detail No.: 20.53

Date: March 2014

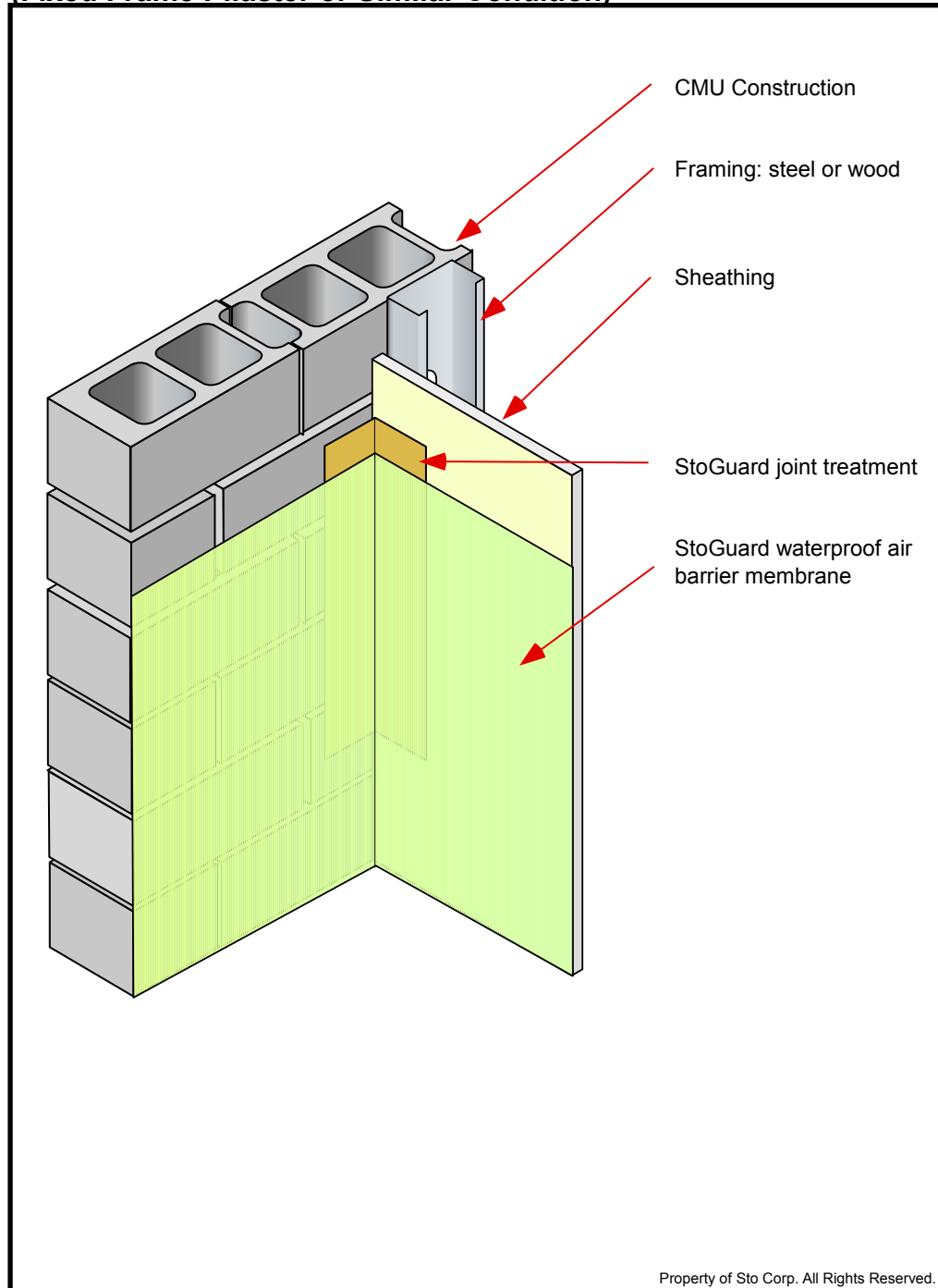

Notes:

- 1] StoGuard joint treatment options:
 - A) StoGuard RapidFill
 - B) Sto Gold Fill® with StoGuard Mesh joints $\leq 1/8"$ (3 mm) wide
 - C) StoGuard Fabric with StoGuard waterproof air barrier membrane joints $\leq 1/8"$ (3 mm) wide
 - D) StoGuard RapidSeal™ with StoGuard Mesh - joints $\leq 1/4"$ (6 mm) wide
- 2] StoGuard waterproof air barrier membrane options:
 - A) Sto EmeraldCoat®
 - B) StoGuard VaporSeal™
 - C) Sto AirSeal™
 - D) Sto Gold Coat®

(Use with StoTherm NExT EIF systems)
- 3] Refer to Sto specifications and product bulletins for detailed information on substrates and Sto material options. Additional water-resistive barrier/slip sheet required behind some claddings not shown. Refer to Sto Detail 20.00b for additional information.

IMPORTANT: Components not identified as Sto are furnished by other manufacturers and are not necessarily installed by trades who install the Sto products. Refer to project specific contract documents.

Attention

Sto products are intended for use by qualified professional contractors, not consumers, as a component of a larger construction assembly as specified by a qualified design professional, general contractor or builder. They should be installed in accordance with those specifications and Sto's instructions. Sto Corp. disclaims all, and assumes no, liability for on-site inspections, for its products applied improperly, or by unqualified persons or entities, or as part of an improperly designed or constructed building, for the nonperformance of adjacent building components or assemblies, or for other construction activities beyond Sto's control. Improper use of Sto products or use as part of an improperly designed or constructed larger assembly or building may result in serious damage to Sto products, and to the structure of the building or its components. **STO CORP. DISCLAIMS ALL WARRANTIES EXPRESS OR IMPLIED EXCEPT FOR EXPLICIT LIMITED WRITTEN WARRANTIES ISSUED TO AND ACCEPTED BY BUILDING OWNERS IN ACCORDANCE WITH STO'S WARRANTY PROGRAMS WHICH ARE SUBJECT TO CHANGE FROM TIME TO TIME.** For the fullest, most current information on proper application, clean-up, mixing and other specifications and warranties, cautions and disclaimers, please refer to the Sto Corp. website, www.stocorp.com.

www.stocorp.com

StoGuard® Waterproof Air Barrier Frame Construction Termination at Parapet

Detail No.: 20.60

Date: March 2014

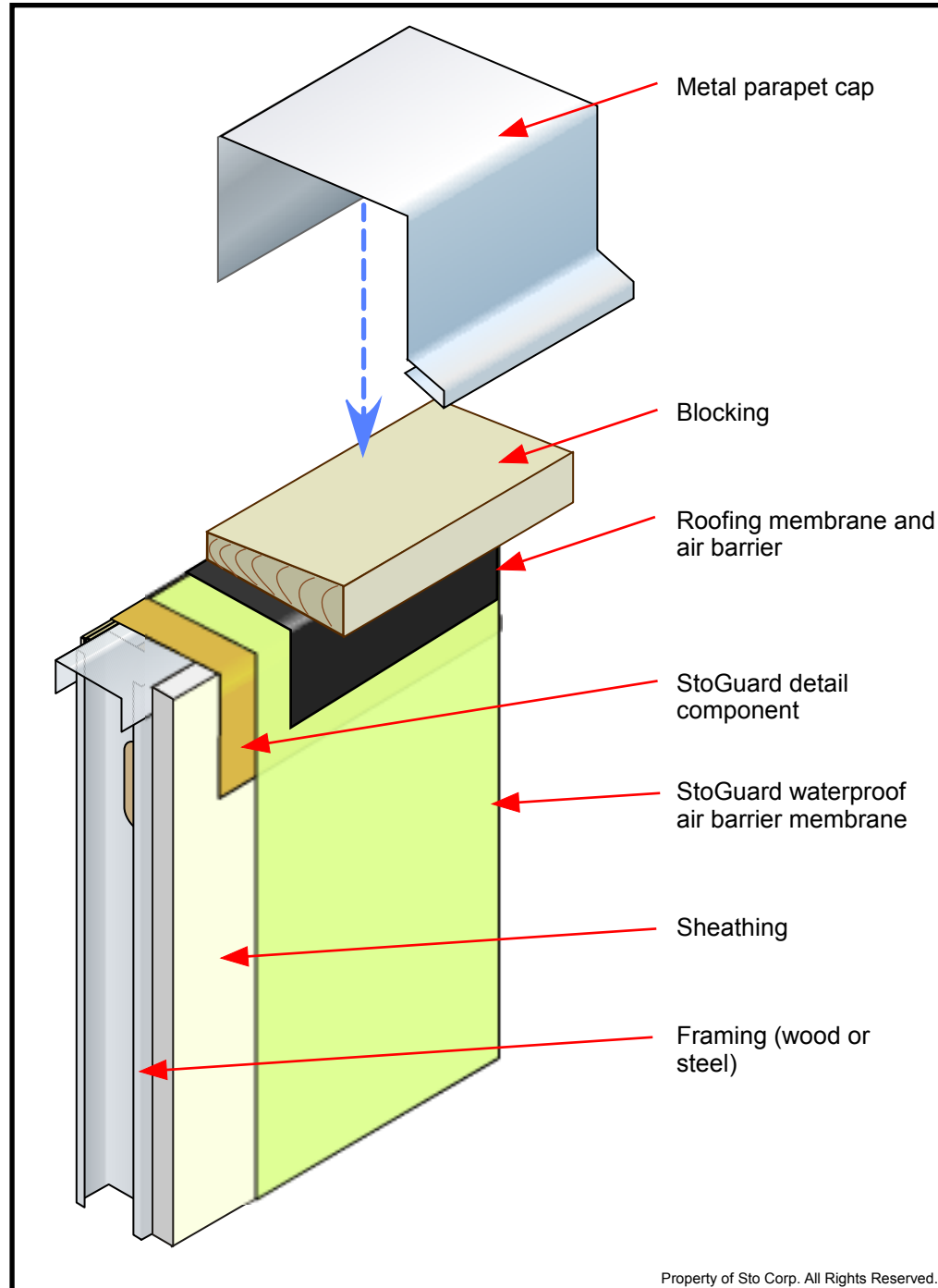

Notes:

- 1] StoGuard detail component options:
 A) StoGuard RapidFill
 B) StoGuard RapidSeal™ with StoGuard® Mesh
 C) Sto Gold Fill® with StoGuard Mesh (top coated with StoGuard waterproof air barrier membrane)
 D) StoGuard Fabric with StoGuard waterproof air barrier membrane
- 2] StoGuard waterproof air barrier membrane options:
 A) Sto EmeraldCoat®
 B) StoGuard VaporSeal™
 C) Sto AirSeal™
 D) Sto Gold Coat®
 (Use with StoTherm NExT EIF systems)
- 3] Verify compatibility of roof membrane materials with StoGuard.
- 4] Verify continuity of roof membrane to waterproof air barrier interface.
- 5] Refer to Sto specifications and product bulletins for detailed information on substrates and Sto material options. Additional water-resistive barrier/slip sheet required behind some claddings not shown. Refer to Sto Detail 20.00b for additional information.

IMPORTANT: Components not identified as Sto are furnished by other manufacturers and are not necessarily installed by trades who install the Sto products. Refer to project specific contract documents.

Property of Sto Corp. All Rights Reserved.

Attention

www.stocorp.com

Sto products are intended for use by qualified professional contractors, not consumers, as a component of a larger construction assembly as specified by a qualified design professional, general contractor or builder. They should be installed in accordance with those specifications and Sto's instructions. Sto Corp. disclaims all, and assumes no, liability for on-site inspections, for its products applied improperly, or by unqualified persons or entities, or as part of an improperly designed or constructed building, for the nonperformance of adjacent building components or assemblies, or for other construction activities beyond Sto's control. Improper use of Sto products or use as part of an improperly designed or constructed larger assembly or building may result in serious damage to Sto products, and to the structure of the building or its components. **STO CORP. DISCLAIMS ALL WARRANTIES EXPRESS OR IMPLIED EXCEPT FOR EXPLICIT LIMITED WRITTEN WARRANTIES ISSUED TO AND ACCEPTED BY BUILDING OWNERS IN ACCORDANCE WITH STO'S WARRANTY PROGRAMS WHICH ARE SUBJECT TO CHANGE FROM TIME TO TIME.** For the fullest, most current information on proper application, clean-up, mixing and other specifications and warranties, cautions and disclaimers, please refer to the Sto Corp. website, www.stocorp.com.

StoGuard[®] Waterproof Air Barrier Frame Construction Saddle Wall Intersection

Detail No.: 22.64

Date: March 2014

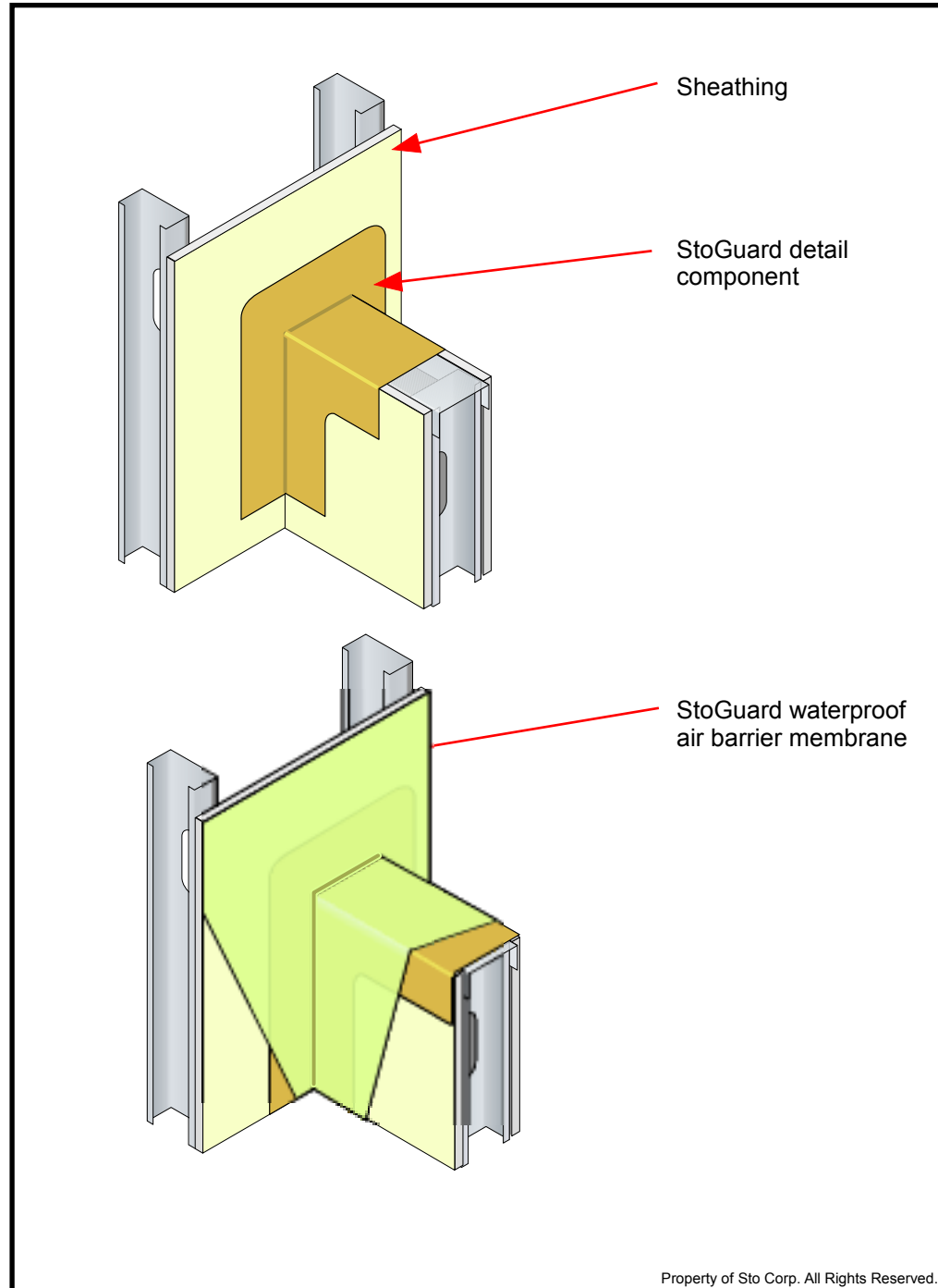

Notes:

- 1] StoGuard detail component options:
 - A) StoGuard RapidFill
 - B) StoGuard RapidSeal™ with StoGuard Mesh
 - C) Sto Gold Fill with StoGuard Mesh top coated with StoGuard waterproof air barrier membrane.
- 2 StoGuard waterproof air barrier membrane options:
 - A) Sto EmeraldCoat®
 - B) StoGuard VaporSeal™
 - C) Sto AirSeal™
 - D) Sto Gold Coat®

(Use with StoTherm NExT EIF systems)
- 3] Refer to Sto specifications and product bulletins for detailed information on substrates and Sto material options. Additional water-resistive barrier/slip sheet required behind some claddings not shown. Refer to Sto Detail 20.00b for additional information.

IMPORTANT: Components not identified as Sto are furnished by other manufacturers and are not necessarily installed by trades who install the Sto products. Refer to project specific contract documents.

Attention

www.stocorp.com

Sto products are intended for use by qualified professional contractors, not consumers, as a component of a larger construction assembly as specified by a qualified design professional, general contractor or builder. They should be installed in accordance with those specifications and Sto's instructions. Sto Corp. disclaims all, and assumes no, liability for on-site inspections, for its products applied improperly, or by unqualified persons or entities, or as part of an improperly designed or constructed building, for the nonperformance of adjacent building components or assemblies, or for other construction activities beyond Sto's control. Improper use of Sto products or use as part of an improperly designed or constructed larger assembly or building may result in serious damage to Sto products, and to the structure of the building or its components. **STO CORP. DISCLAIMS ALL WARRANTIES EXPRESS OR IMPLIED EXCEPT FOR EXPLICIT LIMITED WRITTEN WARRANTIES ISSUED TO AND ACCEPTED BY BUILDING OWNERS IN ACCORDANCE WITH STO'S WARRANTY PROGRAMS WHICH ARE SUBJECT TO CHANGE FROM TIME TO TIME.** For the fullest, most current information on proper application, clean-up, mixing and other specifications and warranties, cautions and disclaimers, please refer to the Sto Corp. website, www.stocorp.com.

StoGuard® Waterproof Air Barrier Frame Construction Mechanical Penetrations

Detail No.: 20.70

Date: March 2014

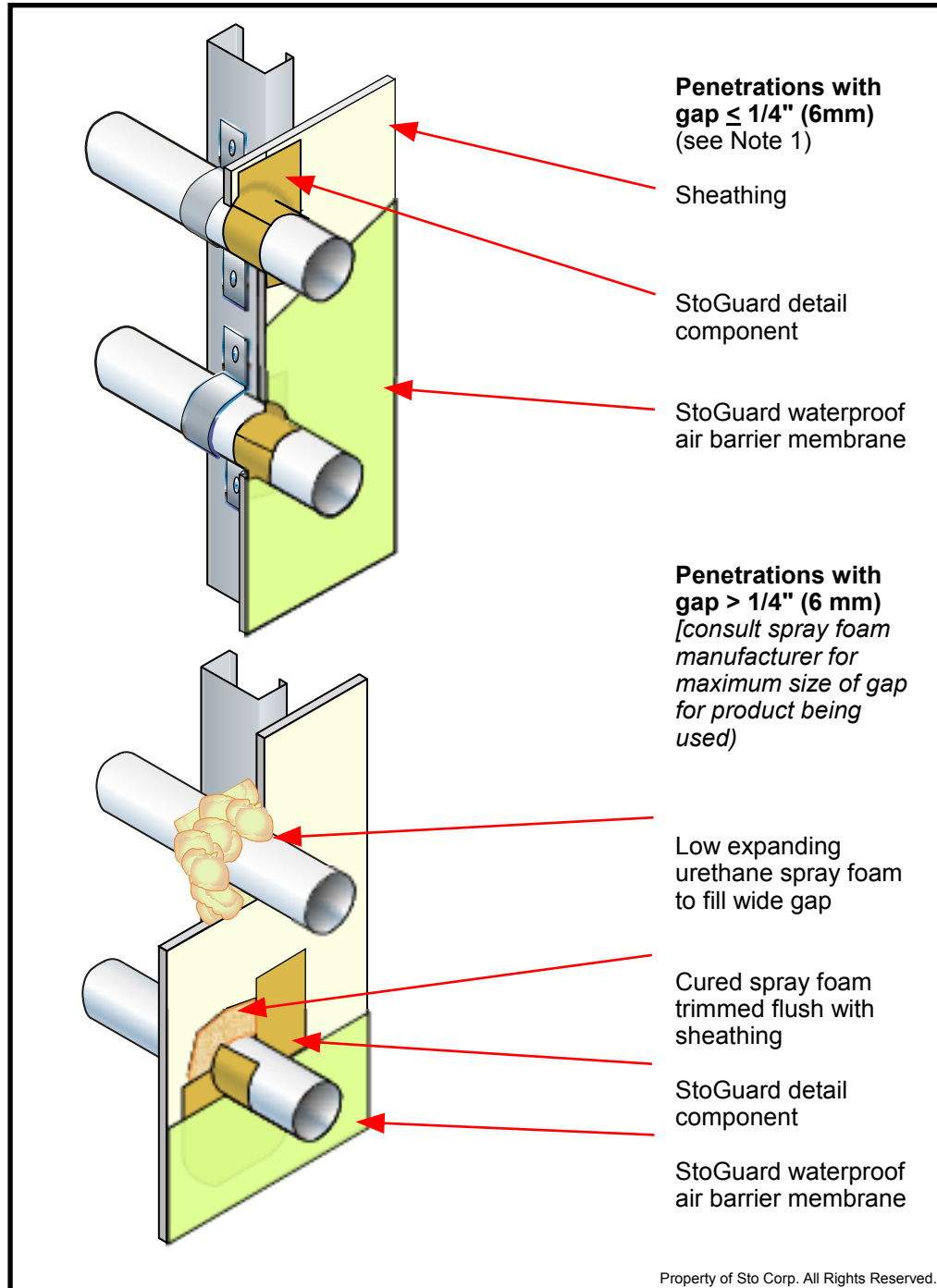

Notes:

- 1] StoGuard detail component options:
 - A) StoGuard RapidFill
 - B) StoGuard RapidSeal™ with StoGuard Mesh
 - C) Sto Gold Fill® with StoGuard Mesh (top coated with StoGuard waterproof air barrier membrane)
 - D) StoGuard Fabric with StoGuard waterproof air barrier membrane- (gaps $\leq 1/8$ " [3 mm])
 - E) StoGuard Tape (with StoGuard Fabric shingle lap)
- 2] StoGuard waterproof air barrier membrane options:
 - A) Sto Gold Coat® (vapor permeable)
 - B) Sto EmeraldCoat® (high perm)
 - C) StoGuard VaporSeal™ (vapor impermeable)
 - D) Sto AirSeal™ (high perm)
- 3] Refer to Sto specifications and product bulletins for detailed information on substrates and Sto material options. Additional water-resistive barrier/slip sheet required behind some claddings not shown. Refer to Sto Detail 20.00b for additional information.

IMPORTANT: Components not identified as Sto are furnished by other manufacturers and are not necessarily installed by trades who install the Sto products. Refer to project specific contract documents.

Attention

Sto products are intended for use by qualified professional contractors, not consumers, as a component of a larger construction assembly as specified by a qualified design professional, general contractor or builder. They should be installed in accordance with those specifications and Sto's instructions. Sto Corp. disclaims all, and assumes no, liability for on-site inspections, for its products applied improperly, or by unqualified persons or entities, or as part of an improperly designed or constructed building, for the nonperformance of adjacent building components or assemblies, or for other construction activities beyond Sto's control. Improper use of Sto products or use as part of an improperly designed or constructed larger assembly or building may result in serious damage to Sto products, and to the structure of the building or its components. **STO CORP. DISCLAIMS ALL WARRANTIES EXPRESS OR IMPLIED EXCEPT FOR EXPLICIT LIMITED WRITTEN WARRANTIES ISSUED TO AND ACCEPTED BY BUILDING OWNERS IN ACCORDANCE WITH STO'S WARRANTY PROGRAMS WHICH ARE SUBJECT TO CHANGE FROM TIME TO TIME.** For the fullest, most current information on proper application, clean-up, mixing and other specifications and warranties, cautions and disclaimers, please refer to the Sto Corp. website, www.stocorp.com.

www.stocorp.com

StoGuard® Waterproof Air Barrier Frame Construction Scupper

Detail No.: 20.75

Date: March 2014

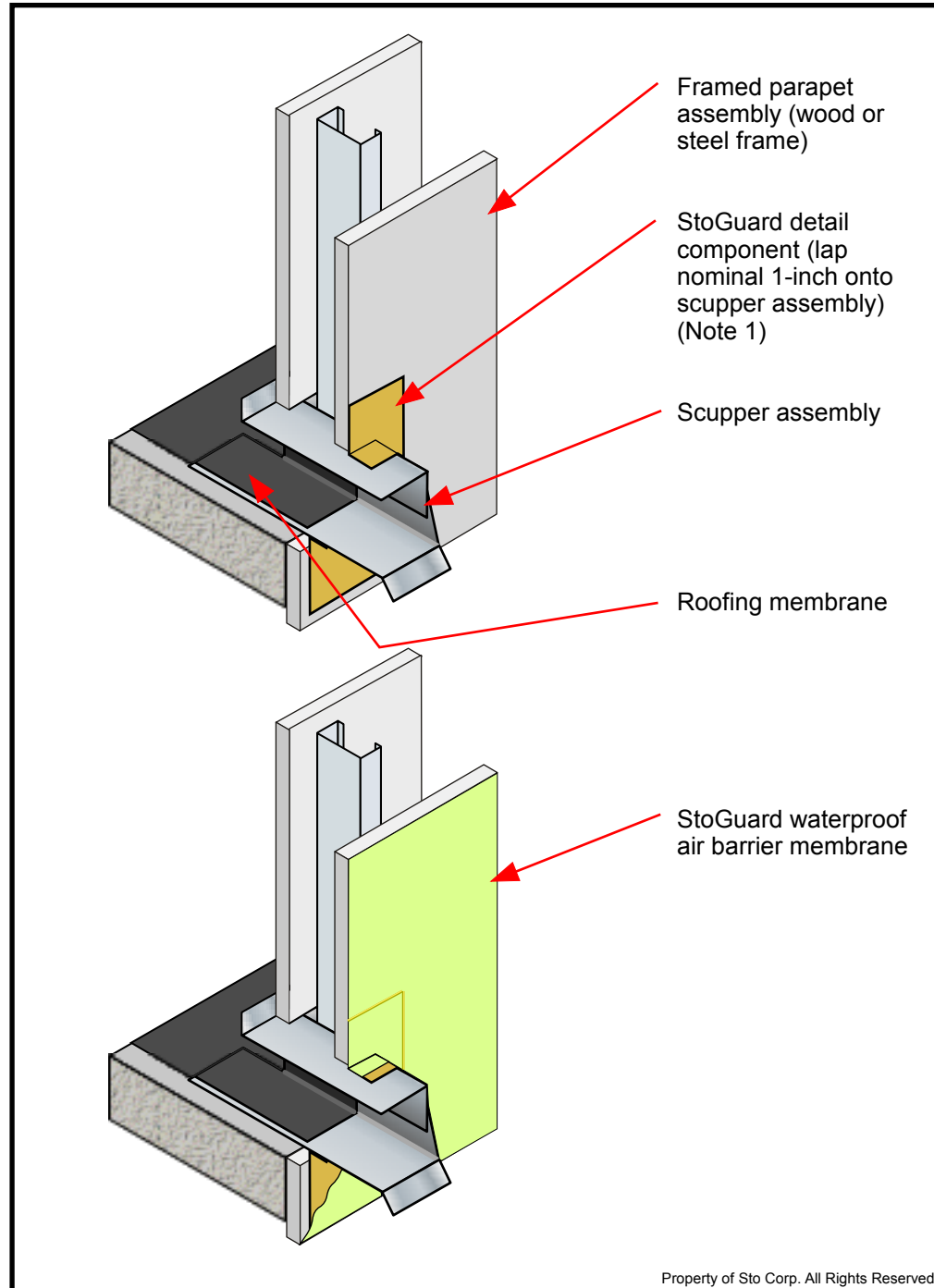

Notes:

- 1] StoGuard detail component options:
 A) StoGuard RapidFill
 B) StoGuard RapidSeal™ with StoGuard Mesh
 C) Sto Gold Fill® with StoGuard Mesh (top coated with StoGuard waterproof air barrier membrane)
 D) StoGuard Fabric with StoGuard waterproof air barrier membrane- (gaps ≤ 1/8" [3 mm])
 E) StoGuard Tape (with StoGuard Fabric shingle lap)
- 2] Prepare opening prior to the installation of the window or mechanical equipment. Provide sill wedge or other means of positive slope to exterior at sill.
- 3] Verify compatibility of roof membrane materials with StoGuard.
- 4] Verify continuity of roof membrane to waterproof air barrier interface.
- 5] Refer to Sto specifications and product bulletins for detailed information on substrates and Sto material options. Additional water-resistive barrier/slip sheet required behind some claddings not shown. Refer to Sto Detail 20.00b for additional information.

IMPORTANT: Components not identified as Sto are furnished by other manufacturers and are not necessarily installed by trades who install the Sto products. Refer to project specific contract documents.

Attention

www.stocorp.com

Sto products are intended for use by qualified professional contractors, not consumers, as a component of a larger construction assembly as specified by a qualified design professional, general contractor or builder. They should be installed in accordance with those specifications and Sto's instructions. Sto Corp. disclaims all, and assumes no, liability for on-site inspections, for its products applied improperly, or by unqualified persons or entities, or as part of an improperly designed or constructed building, for the nonperformance of adjacent building components or assemblies, or for other construction activities beyond Sto's control. Improper use of Sto products or use as part of an improperly designed or constructed larger assembly or building may result in serious damage to Sto products, and to the structure of the building or its components. **STO CORP. DISCLAIMS ALL WARRANTIES EXPRESS OR IMPLIED EXCEPT FOR EXPLICIT LIMITED WRITTEN WARRANTIES ISSUED TO AND ACCEPTED BY BUILDING OWNERS IN ACCORDANCE WITH STO'S WARRANTY PROGRAMS WHICH ARE SUBJECT TO CHANGE FROM TIME TO TIME.** For the fullest, most current information on proper application, clean-up, mixing and other specifications and warranties, cautions and disclaimers, please refer to the Sto Corp. website, www.stocorp.com.